



Models VSI/IVSI

Stainless Steel Double Wall
Positive Pressure Venting Systems



AMPCO Commercial Models VSI/IVSI are modular, prefabricated venting systems featuring quick assembly, pressure-sealing capabilities and temperature ratings up to 1400 °F with low clearance to combustibles.



Venting/Exhaust Applications Commercial & Industrial

- Boilers
- Generators/Engines/Turbines
- CHP (Co-Generation)
- Dryer Exhaust
- Laboratory Fume Hoods
- Kitchen Exhaust/Grease Duct
- Pizza Ovens
- Coffee Roasters
- Water Heaters
- Furnaces



Table of Contents

UNDERWRITERS LABORATORIES LISTINGS

Model VSI and IVSI in sizes 5" through 48" diameters have been tested and Listed (Safety Certified) by Underwriters Laboratories, Inc. and bears the UL and/or c-UL logo signifying compliance with U.S. and/or Canadian standards. UL Listing product categories include:

(USA)

Grease Duct (UL1978) (UL2221)
Building Heating Appliance Chimney (UL103)
(Industrial) 1400° F Chimney (UL2561)
Type L Vent (Model IVSI only) (UL641)
Type B Gas Vent (UL441)
Special Gas Vent (UL1738)*

(Canada)

Grease Duct (ULC-S662) (ULC-S144)
540°C (1000°F) Industrial Chimney (ULC-C959)
760°C (1400°F) Industrial Chimney
Type BH Gas Vent (ULC-S636)*

*For Special Gas Vent application, please reference AMPCO SGV catalog and instructions for proper material selection and installation requirements; application requires grade 316 stainless steel inner wall and SGV-550 sealant.

UL file numbers for VSI and IVSI include MH6673, MH11382, MH16161 and R21679.

CODE AND STANDARD COMPLIANCE

NFPA (NFPA, 31, 37, 54, 96, 211)
ICC (IMC, IFGC)
IAMPO (UMC)
NBC

Model VSI and IVSI have been approved by the City of New York Department of Buildings, Materials and Equipment Acceptance Division under the following MEA numbers:

	Model VSI	Model IVSI
Building Heating Appliance Chimney	MEA 132-90M	MEA 135-90M
1400° F Chimney	MEA 133-90M	MEA 181-90M
Grease Duct	MEA 134-90M	MEA 134-90M

ASSOCIATION/COMMITTEE PARTICIPATION



• System Overview	4-5
• Guide to Component Parts	6
• Product Identification	7
• Joint Assembly Parts	8-9
• Sealants	9
• Double Wall Pipe	10
• Adjustable/Variable Pipe	10-11
• Double Wall Fittings	11-17
• Support/Guide Accessories	18-19
• Connection Accessories	19-21
• Roof Penetrations	22-24
• Terminations	25-27
• Miscellaneous	28-30
• Special Parts	31
• Technical Data	32-33

AMPCO Sizing/Pressure Calculations

AMPCO
endurvent

AMPCO Sizing/Pressure Calculations Form
Form No. 100-1001
Rev. 10/10/10

FOR PROFESSIONAL CALCULATIONS AND CONSULTING, SEE THE INSTRUCTIONS ON THE REVERSE SIDE OF THIS FORM. THE PROFESSIONAL PRODUCTS GROUP ASSUMES NO RESPONSIBILITY FOR FIELD USES OR ADAPTATIONS. CALCULATIONS SHOULD BE VERIFIED BY A LICENSED PROFESSIONAL ENGINEER.

NAME: _____ DATE: _____ PROJECT: _____

PROJECT: _____

PREPARED BY: _____

Check Type: _____

1. Natural Gas or Propane

2. Other Gas

3. Other Gas

4. Other Gas

5. Other Gas

6. Other Gas

7. Other Gas

8. Other Gas

9. Other Gas

10. Other Gas

11. Other Gas

12. Other Gas

13. Other Gas

14. Other Gas

15. Other Gas

16. Other Gas

17. Other Gas

18. Other Gas

19. Other Gas

20. Other Gas

21. Other Gas

22. Other Gas

23. Other Gas

24. Other Gas

25. Other Gas

26. Other Gas

27. Other Gas

28. Other Gas

29. Other Gas

30. Other Gas

31. Other Gas

32. Other Gas

33. Other Gas

34. Other Gas

35. Other Gas

36. Other Gas

37. Other Gas

38. Other Gas

39. Other Gas

40. Other Gas

41. Other Gas

42. Other Gas

43. Other Gas

44. Other Gas

45. Other Gas

46. Other Gas

47. Other Gas

48. Other Gas

49. Other Gas

50. Other Gas

51. Other Gas

52. Other Gas

53. Other Gas

54. Other Gas

55. Other Gas

56. Other Gas

57. Other Gas

58. Other Gas

59. Other Gas

60. Other Gas

61. Other Gas

62. Other Gas

63. Other Gas

64. Other Gas

65. Other Gas

66. Other Gas

67. Other Gas

68. Other Gas

69. Other Gas

70. Other Gas

71. Other Gas

72. Other Gas

73. Other Gas

74. Other Gas

75. Other Gas

76. Other Gas

77. Other Gas

78. Other Gas

79. Other Gas

80. Other Gas

81. Other Gas

82. Other Gas

83. Other Gas

84. Other Gas

85. Other Gas

86. Other Gas

87. Other Gas

88. Other Gas

89. Other Gas

90. Other Gas

91. Other Gas

92. Other Gas

93. Other Gas

94. Other Gas

95. Other Gas

96. Other Gas

97. Other Gas

98. Other Gas

99. Other Gas

100. Other Gas

101. Other Gas

102. Other Gas

103. Other Gas

104. Other Gas

105. Other Gas

106. Other Gas

107. Other Gas

108. Other Gas

109. Other Gas

110. Other Gas

111. Other Gas

112. Other Gas

113. Other Gas

114. Other Gas

115. Other Gas

116. Other Gas

117. Other Gas

118. Other Gas

119. Other Gas

120. Other Gas

121. Other Gas

122. Other Gas

123. Other Gas

124. Other Gas

125. Other Gas

126. Other Gas

127. Other Gas

128. Other Gas

129. Other Gas

130. Other Gas

131. Other Gas

132. Other Gas

133. Other Gas

134. Other Gas

135. Other Gas

136. Other Gas

137. Other Gas

138. Other Gas

139. Other Gas

140. Other Gas

141. Other Gas

142. Other Gas

143. Other Gas

144. Other Gas

145. Other Gas

146. Other Gas

147. Other Gas

148. Other Gas

149. Other Gas

150. Other Gas

151. Other Gas

152. Other Gas

153. Other Gas

154. Other Gas

155. Other Gas

156. Other Gas

157. Other Gas

158. Other Gas

159. Other Gas

160. Other Gas

161. Other Gas

162. Other Gas

163. Other Gas

164. Other Gas

165. Other Gas

166. Other Gas

167. Other Gas

168. Other Gas

169. Other Gas

170. Other Gas

171. Other Gas

172. Other Gas

173. Other Gas

174. Other Gas

175. Other Gas

176. Other Gas

177. Other Gas

178. Other Gas

179. Other Gas

180. Other Gas

181. Other Gas

182. Other Gas

183. Other Gas

184. Other Gas

185. Other Gas

186. Other Gas

187. Other Gas

188. Other Gas

189. Other Gas

190. Other Gas

191. Other Gas

192. Other Gas

193. Other Gas

194. Other Gas

195. Other Gas

196. Other Gas

197. Other Gas

198. Other Gas

199. Other Gas

200. Other Gas

201. Other Gas

202. Other Gas

203. Other Gas

204. Other Gas

205. Other Gas

206. Other Gas

207. Other Gas

208. Other Gas

209. Other Gas

210. Other Gas

211. Other Gas

212. Other Gas

213. Other Gas

214. Other Gas

215. Other Gas

216. Other Gas

217. Other Gas

218. Other Gas

219. Other Gas

220. Other Gas

221. Other Gas

222. Other Gas

223. Other Gas

224. Other Gas

225. Other Gas

226. Other Gas

227. Other Gas

228. Other Gas

229. Other Gas

230. Other Gas

231. Other Gas

232. Other Gas

233. Other Gas

234. Other Gas

235. Other Gas

236. Other Gas

237. Other Gas

238. Other Gas

239. Other Gas

240. Other Gas

241. Other Gas

242. Other Gas

243. Other Gas

244. Other Gas

245. Other Gas

246. Other Gas

247. Other Gas

248. Other Gas

249. Other Gas

250. Other Gas

251. Other Gas

252. Other Gas

253. Other Gas

254. Other Gas

255. Other Gas

256. Other Gas

257. Other Gas

258. Other Gas

259. Other Gas

260. Other Gas

261. Other Gas

262. Other Gas

263. Other Gas

264. Other Gas

265. Other Gas

266. Other Gas

267. Other Gas

268. Other Gas

269. Other Gas

270. Other Gas

271. Other Gas

272. Other Gas

273. Other Gas

274. Other Gas

275. Other Gas

276. Other Gas

277. Other Gas

278. Other Gas

279. Other Gas

280. Other Gas

281. Other Gas

282. Other Gas

283. Other Gas

284. Other Gas

285. Other Gas

286. Other Gas

287. Other Gas

288. Other Gas

289. Other Gas

290. Other Gas

291. Other Gas

292. Other Gas

293. Other Gas

294. Other Gas

295. Other Gas

296. Other Gas

297. Other Gas

298. Other Gas

299. Other Gas

300. Other Gas

301. Other Gas

302. Other Gas

303. Other Gas

304. Other Gas

305. Other Gas

306. Other Gas

307. Other Gas

308. Other Gas

309. Other Gas

310. Other Gas

311. Other Gas

312. Other Gas

313. Other Gas

314. Other Gas

315. Other Gas

316. Other Gas

317. Other Gas

318. Other Gas

319. Other Gas

320. Other Gas

321. Other Gas

322. Other Gas

323. Other Gas

324. Other Gas

325. Other Gas

326. Other Gas

327. Other Gas

328. Other Gas

329. Other Gas

330. Other Gas

331. Other Gas

332. Other Gas

333. Other Gas

334. Other Gas

335. Other Gas

336. Other Gas

337. Other Gas

338. Other Gas

339. Other Gas

340. Other Gas

341. Other Gas

342. Other Gas

343. Other Gas

344. Other Gas

345. Other Gas

346. Other Gas

347. Other Gas

348. Other Gas

349. Other Gas

350. Other Gas

351. Other Gas

352. Other Gas

353. Other Gas

354. Other Gas

355. Other Gas

356. Other Gas

357. Other Gas

358. Other Gas

359. Other Gas

360. Other Gas

361. Other Gas

362. Other Gas

363. Other Gas

364. Other Gas

365. Other Gas

366. Other Gas

367. Other Gas

368. Other Gas

369. Other Gas

370. Other Gas

371. Other Gas

372. Other Gas

373. Other Gas

374. Other Gas

375. Other Gas

376. Other Gas

377. Other Gas

378. Other Gas

379. Other Gas

380. Other Gas

381. Other Gas

382. Other Gas

383. Other Gas

384. Other Gas

385. Other Gas

386. Other Gas

387. Other Gas

388. Other Gas

389. Other Gas

390. Other Gas

391. Other Gas

392. Other Gas

393. Other Gas

394. Other Gas

395. Other Gas

396. Other Gas

397. Other Gas

398. Other Gas

399. Other Gas

400. Other Gas

401. Other Gas

402. Other Gas

403. Other Gas

404. Other Gas

405. Other Gas

406. Other Gas

407. Other Gas

408. Other Gas

409. Other Gas

410. Other Gas

411. Other Gas

412. Other Gas

413. Other Gas

414. Other Gas

415. Other Gas

416. Other Gas

417. Other Gas

418. Other Gas

419. Other Gas

420. Other Gas

421. Other Gas

422. Other Gas

423. Other Gas

424. Other Gas

425. Other Gas

426. Other Gas

427. Other Gas

428. Other Gas

429. Other Gas

430. Other Gas

431. Other Gas

432. Other Gas

433. Other Gas

434. Other Gas

435. Other Gas

436. Other Gas

437. Other Gas

438. Other Gas

439. Other Gas

440. Other Gas

441. Other Gas

442. Other Gas

443. Other Gas

444. Other Gas

445. Other Gas

446. Other Gas

447. Other Gas

448. Other Gas

449. Other Gas

450. Other Gas

451. Other Gas

452. Other Gas

453. Other Gas

454. Other Gas

455. Other Gas

456. Other Gas

457. Other Gas

458. Other Gas

459. Other Gas

460. Other Gas

461. Other Gas

462. Other Gas

463. Other Gas

464. Other Gas

465. Other Gas

466. Other Gas

467. Other Gas

468. Other Gas

469. Other Gas

470. Other Gas

471. Other Gas

472. Other Gas

473. Other Gas

474. Other Gas

475. Other Gas

476. Other Gas

477. Other Gas

478. Other Gas

479. Other Gas

480. Other Gas

481. Other Gas

482. Other Gas

483. Other Gas

484. Other Gas

485. Other Gas

486. Other Gas

487. Other Gas

488. Other Gas

489. Other Gas

490. Other Gas

491. Other Gas

492. Other Gas

493. Other Gas

494. Other Gas

495. Other Gas

496. Other Gas

497. Other Gas

498. Other Gas

499. Other Gas

500. Other Gas

501. Other Gas

502. Other Gas

503. Other Gas

504. Other Gas

505. Other Gas

506. Other Gas

507. Other Gas

508. Other Gas

509. Other Gas

510. Other Gas

511. Other Gas

512. Other Gas

513. Other Gas

514. Other Gas

515. Other Gas

516. Other Gas

517. Other Gas

518. Other Gas

519. Other Gas

520. Other Gas

521. Other Gas

522. Other Gas

523. Other Gas

524. Other Gas

525. Other Gas

526. Other Gas

527. Other Gas

528. Other Gas

529. Other Gas

530. Other Gas

531. Other Gas

532. Other Gas

533. Other Gas

534. Other Gas

535. Other Gas

536. Other Gas

537. Other Gas

538. Other Gas

539. Other Gas

540. Other Gas

541. Other Gas

542. Other Gas

543. Other Gas

544. Other Gas

545. Other Gas

546. Other Gas

547. Other Gas

548. Other Gas

549. Other Gas

550. Other Gas

551. Other Gas

552. Other Gas

553. Other Gas

554. Other Gas

555. Other Gas

556. Other Gas

557. Other Gas

558. Other Gas

559. Other Gas

560. Other Gas

561. Other Gas

562. Other Gas

563. Other Gas

564. Other Gas

565. Other Gas

566. Other Gas

567. Other Gas

568. Other Gas

569. Other Gas

570. Other Gas

571. Other Gas

572. Other Gas

573. Other Gas

574. Other Gas

575. Other Gas

576. Other Gas

577. Other Gas

578. Other Gas

579. Other Gas

580. Other Gas

581. Other Gas

582. Other Gas

583. Other Gas

584. Other Gas

585. Other Gas

586. Other Gas

587. Other Gas

588. Other Gas

589. Other Gas

590. Other Gas

591. Other Gas

592. Other Gas

593. Other Gas

594. Other Gas

595. Other Gas

596. Other Gas

597. Other Gas

598. Other Gas

599. Other Gas

600. Other Gas

601. Other Gas

602. Other Gas

603. Other Gas

604. Other Gas

605. Other Gas

606. Other Gas

607. Other Gas

608. Other Gas

609. Other Gas

610. Other Gas

611. Other Gas

612. Other Gas

613. Other Gas

614. Other Gas

615. Other Gas

616. Other Gas

617. Other Gas

618. Other Gas

619. Other Gas

620. Other Gas

621. Other Gas

622. Other Gas

623. Other Gas

624. Other Gas

625. Other Gas

626. Other Gas

627. Other Gas

628. Other Gas

629. Other Gas

630. Other Gas

631. Other Gas

632. Other Gas

633. Other Gas

634. Other Gas

635. Other Gas

636. Other Gas

637. Other Gas

638. Other Gas

639. Other Gas

640. Other Gas

641. Other Gas

642. Other Gas

643. Other Gas

644. Other Gas

645. Other Gas

646. Other Gas

647. Other Gas

648. Other Gas

649. Other Gas

650. Other Gas

651. Other Gas

652. Other Gas

653. Other Gas

654. Other Gas

655. Other Gas

656. Other Gas

657. Other Gas

658. Other Gas

659. Other Gas

660. Other Gas

661. Other Gas

662. Other Gas

663. Other Gas

664. Other Gas

665. Other Gas

666. Other Gas

667. Other Gas

668. Other Gas

669. Other Gas

670. Other Gas

671. Other Gas

672. Other Gas

673. Other Gas

674. Other Gas

675. Other Gas

676. Other Gas

677. Other Gas

678. Other Gas

679. Other Gas

680. Other Gas

681. Other Gas

682. Other Gas

683. Other Gas

684. Other Gas

685. Other Gas

686. Other Gas

687. Other Gas

688. Other Gas

689. Other Gas

690. Other Gas

691. Other Gas

692. Other Gas

693. Other Gas

694. Other Gas

695. Other Gas

696. Other Gas

697. Other Gas

698. Other Gas

699. Other Gas

700. Other Gas

701. Other Gas

702. Other Gas

703. Other Gas

704. Other Gas

705. Other Gas

706. Other Gas

707. Other Gas

708. Other Gas

709. Other Gas

710. Other Gas

711. Other Gas

712. Other Gas

713. Other Gas

714. Other Gas

715. Other Gas

716. Other Gas

717. Other Gas

718. Other Gas

719. Other Gas

720. Other Gas

721. Other Gas

722. Other Gas

723. Other Gas

724. Other Gas

725. Other Gas

726. Other Gas

727. Other Gas

728. Other Gas

729. Other Gas

730. Other Gas

731. Other Gas

732. Other Gas

733. Other Gas

734. Other Gas

735. Other Gas

736. Other Gas

737. Other Gas

738. Other Gas

739. Other Gas

740. Other Gas

741. Other Gas

742. Other Gas

743. Other Gas

744. Other Gas

745. Other Gas

746. Other Gas

747. Other Gas

748. Other Gas

749. Other Gas

750. Other Gas

751. Other Gas

752. Other Gas

753. Other Gas

754. Other Gas

755. Other Gas

756. Other Gas

757. Other Gas

758. Other Gas

759. Other Gas

760. Other Gas

761. Other Gas

762. Other Gas

763. Other Gas

764. Other Gas

765. Other Gas

766. Other Gas

767. Other Gas

768. Other Gas

769. Other Gas

770. Other Gas

771. Other Gas

772. Other Gas

773. Other Gas

774. Other Gas

775. Other Gas

776. Other Gas

777. Other Gas

778. Other Gas

779. Other Gas

780. Other Gas

781. Other Gas

782. Other Gas

783. Other Gas

784. Other Gas

785. Other Gas

786. Other Gas

787. Other Gas

788. Other Gas

789. Other Gas

790. Other Gas

791. Other Gas

792. Other Gas

793. Other Gas

794. Other Gas

795. Other Gas

796. Other Gas

797. Other Gas

798. Other Gas

799. Other Gas

800. Other Gas

801. Other Gas

802. Other Gas

803. Other Gas

804. Other Gas

805. Other Gas

806. Other Gas

807. Other Gas

808. Other Gas

809. Other Gas

810. Other Gas

811. Other Gas

812. Other Gas

813. Other Gas

814. Other Gas

815. Other Gas

816. Other Gas

817. Other Gas

818. Other Gas

819. Other Gas

820. Other Gas

821. Other Gas

822. Other Gas

823. Other Gas

824. Other Gas

825. Other Gas

826. Other Gas

827. Other Gas

828. Other Gas

829. Other Gas

830. Other Gas

831. Other Gas

832. Other Gas

833. Other Gas

834. Other Gas

835. Other Gas

836. Other Gas

837. Other Gas

838. Other Gas

839. Other Gas

840. Other Gas

841. Other Gas

842. Other Gas

843. Other Gas

844. Other Gas

845. Other Gas

846. Other Gas

847. Other Gas

848. Other Gas

849. Other Gas

850. Other Gas

851. Other Gas

852. Other Gas

853. Other Gas

854. Other Gas

855. Other Gas

856. Other Gas

857. Other Gas

858. Other Gas

859. Other Gas

860. Other Gas

861. Other Gas

862. Other Gas

863. Other Gas

864. Other Gas

865. Other Gas

866. Other Gas

867. Other Gas

868. Other Gas

869. Other Gas

870. Other Gas

871. Other Gas

872. Other Gas

873. Other Gas

874. Other Gas

875. Other Gas

876. Other Gas

877. Other Gas

878. Other Gas

879. Other Gas

880. Other Gas

881. Other Gas

882. Other Gas

883. Other Gas

884. Other Gas

885. Other Gas

886. Other Gas

887. Other Gas

888. Other Gas

System Overview

AMPCO Model VSI and IVSI are modular, prefabricated piping systems which embody flanged joints designed for both quick assembly and pressure-sealing capabilities. They offer a combination of insulated piping components as well as the structural accessories needed for support and attachment to building structures. Expansion joints are available both in gasket designs and in pressure tight, all-welded bellows designs.

Standard gas-carrying piping parts are usable for a wide variety of applications:

- Chimneys and stacks for all types of building heating equipment.
- Chimneys for industrial ovens, furnaces and processing equipment.
- Exhaust piping for engines or turbine units.
- Ducting in restaurants for compliance with Type 1 hood requirements.
- Ducting for heated air and combustion products.
- Ducting for light duty pollution control equipment.
- Venting for engine exhaust.
- Venting for offshore drilling rigs.

Complete Line of Fittings

Model VSI and IVSI are available in eighteen sizes, from 5" I.D. to 48" I.D. Fittings include various elbows, tees, supports and terminations, as well as a variety of accessory fittings designed to make installation simple and quick.

Each component is shipped complete and ready for installation. Each ordered part includes Inner Vee Bands, Outer Channel Bands and all the necessary hardware.

All items included with each order are listed in this catalog under the part description.

Thermal Expansion Aspects

The flange-to-flange joints of the Model IVSI inner pipe transmit axial thermal expansion movements and forces in the same manner as continuous welded pipe. In addition, the expansion of the 300 Series Stainless Steel is approximately 50% greater than that of ordinary low carbon steel and can be estimated as one inch per 100°F rise in gas temperature per 100' (50' at 300°F will expand 1.5"). It is important to calculate this expansion and allow for it by using a suitable Bellows Joint (Part No. BJ) or an Adjustable Length (Part No. AG) wherever the expansion might exceed 1/4". This AG fitting, which comprises a closely fitting sliding internal section with a graphite packing seal and a sliding outer section, can be used to absorb these movement.



Exceeding the Requirements

AMPCO, inventors of the positive pressure system concept, far exceeds the requirements of codes and other manufacturers. Results of our testing programs illustrate this fact.

Leak Tests

AMPCO conducted system pressure testing (to 60" w.c.) against leakage in the presence of UL inspectors. Results of these tests are impressive. Using the OSHA occupation standard-of-leakage rate of 50 parts per million over an eight hour period as criterion for acceptance, the AMPCO system was tested to a leakage rate of only .144 parts per million, or three-tenths of one percent (.3%) of the maximum allowable leakage per UL103 test standard.

Seismic Tests

We further demonstrated the superiority of the Model VSI and IVSI concept by conducting seismic load tests. These tests proved the structural integrity of our products under severe stress by showing that a guyed stack measuring 20 inches in diameter and exceeding 10 feet above the guying location (installed in strict accordance with the UL103 Listing) could withstand the rigors of all seismic zones.

Structural Tests

AMPCO recently tested for greater freestanding limits (termination height above a guide point). These tests, simulating stack performance under 110 mph wind conditions, again demonstrated the superiority of AMPCO products.

Skin Temperature Rise Tests

Among other things, UL103 covers the temperature rise limits of the surrounding combustible materials in an unenclosed chimney installation - and it defines the test set-up to measure the actual temperature rise of those materials at the OEM recommended clearances. Our published Model IVSI skin temperatures were obtained during these tests.

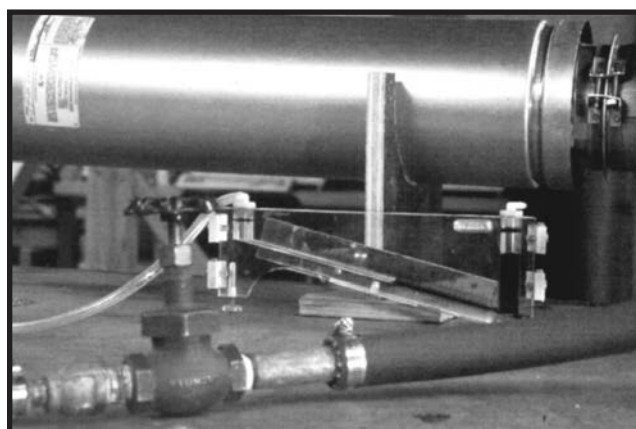
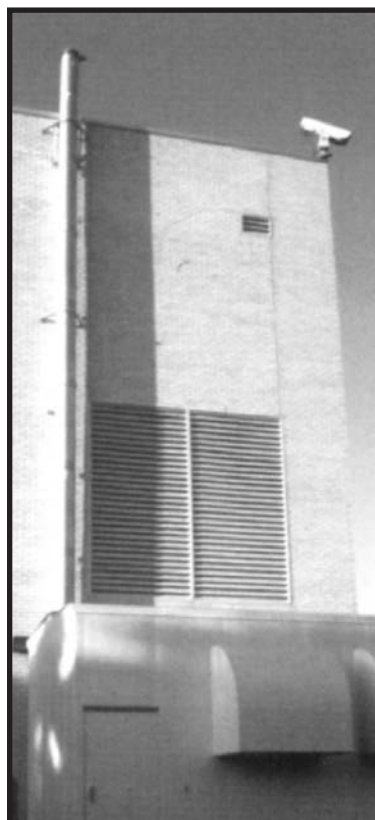

This page illustrates some of the major parts described on pages 8-30.

Product	Code	page	Product	Code	page	Product	Code	page
Joint Assembly Parts			Double Wall Fittings (cont)			Roof Penetrations		
Overlapping Vee Band	VB	8	Drain Tee Cap	TC	13	Storm Collar	SC	22
Alignment Sleeve	AS	8	Clean Out Tee Cap	TCN	14	Tall Flashing	TF	22
Channel Band	CB	8	15° Elbow	EL15	14	Pitched Tall Flashing	PTF	22
Half Channel Band	HCB	8	30° Elbow	EL30	15	Ventilated Thimble	THB	23
Low Temperature Sealant	P600	8	45° Elbow	EL45	15	Ventilated Tall Flashing	VTF	23
High Temperature Sealant	P2000	8	90° Elbow	EL90	16	Ventilated Storm Collar	VSC	23
Special Gas Vent Sealant	SGV550	8	Tapered Increaser	OT	16	Ventilated Thimble Assembly	MVT	23
Double Wall Pipe			Step Increaser	OS	17	Ventilated Support Assembly	MRS	24
59.13" Pipe Length	59	10	Drain Section	DS	17	Pitched Ventilated Thimble	PVT	24
42" Pipe Length	42	10	Support/Guide Accessories			Terminations		
30" Pipe Length	30	10	Half Angle Ring	HR	18	Closure Ring	CR	25
18" Pipe Length	18	10	Full Angle Ring	FR	18	Chimney Top	CT	25
Adjustable/Variable Pipe			Plate Support Assembly	PA	18	Stack Cap	SK	26
30" Adjustable Pipe	AG30	10	Wall Support Assembly	WA	18	Exit Cone	EC	26
18" Adjustable Pipe	AG18	10	Wall Guide Assembly	WG	19	Flip Top	FL	27
Bellows Joint	BJ	11	Floor Guide Assembly	FG	19	Miter Cut	MC	27
30" Variable Pipe	VL30	11	Support Strap	SS	19	Miscellaneous		
18" Variable Pipe	VL18	11	Connection Accessories			Excessive Pressure Relief Valve	ER	28
Double Wall Fittings			Boiler Kit	BK	19	Guy Section	GS	28
90° Tee	MT	11	Seal Ring	SR	20	No Tool Access Cap	NTAC	29
Combination Lateral Tee	CL	12	Flange Adapter	FD	20	Special Manifold Tee (Sprinkler)		29
45° Tee - Lateral	JL	12	Clamp Flange	CF	20	Through-Penetration Fire Stop	TPF	30
90° Wye	JY	13	Flanged Hood Transition	TS	21	Inline Access Door	IAD	30
			Unflanged Hood Transition	TSU	21			
			Fan Adapter	FA	21			

Note: For details on parts usage, refer to the AMPCO installation instructions.

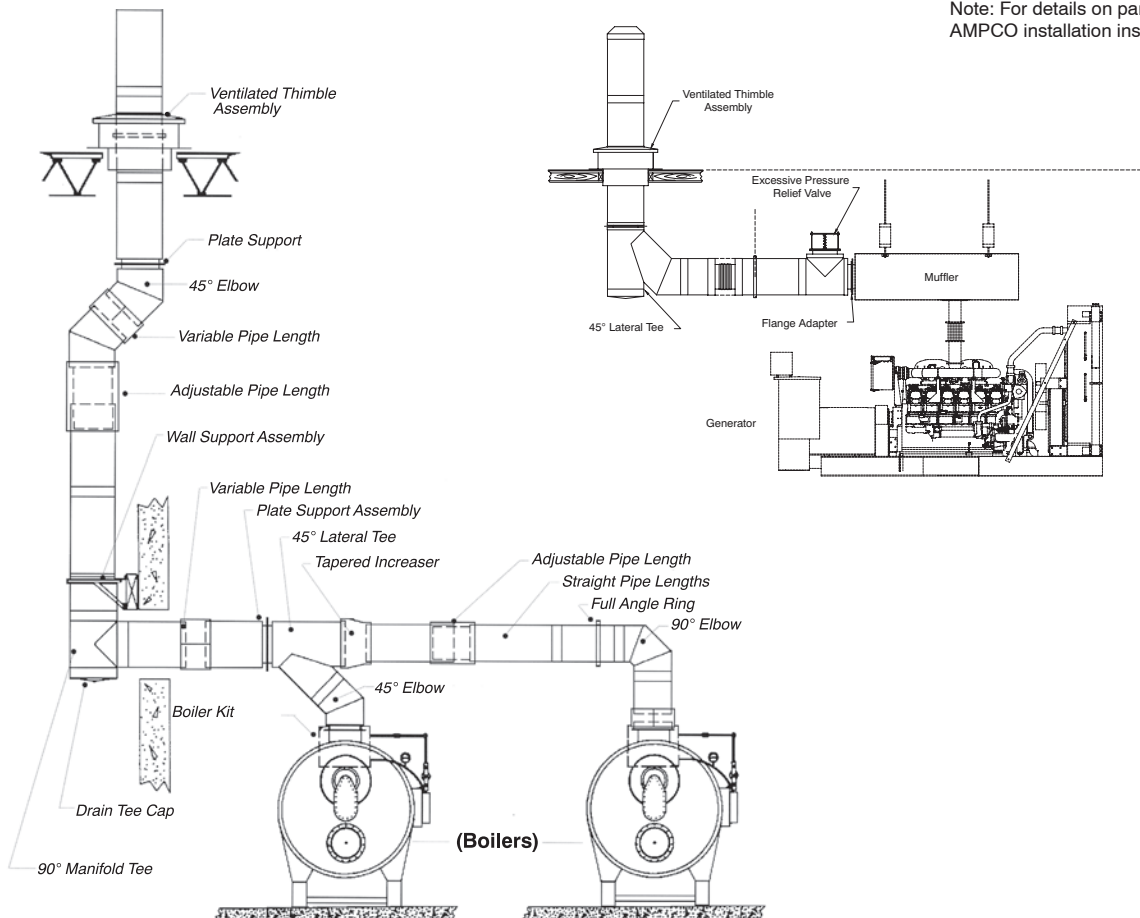

Model VSI vs. Model IVSI



Ceramic fiber insulation increases the diameter of the outer wall:

- Model VSI: 1" air insulation (no ceramic fiber)
- Model IVSI-C: 1", 2" and 4" ceramic fiber insulation
- Model IVSI-Z 3" and 4" dense fiber insulation

OD Calculation	
Model(s)	OD (Inches)
VSI, IVSIC1	OD=ID+2
IVSIC2	OD=ID+4
IVSI-Z3	OD=ID+6
IVSIC4, Z4	OD=ID+8

(Reference AMPCO installation instructions for the clearance to combustibles for specific applications)

Understanding Product Codes and Part Numbers

All parts manufactured by AMPCO are identified by a series of numbers and letters which describe their makeup and function.

Here is how to interpret the Part Number designation for Model VSI and IVSI products.

1. It begins with the pipe or fitting’s internal diameter (in inches) such as 8, 22, 36, etc.

2. This is followed by the Model designation, VSI for air-insulated (Model VSI), or IVSI for parts that are fiber insulated (Model IVSIC1, C2, Z3,C4, or Z4).

3. Next, is the product’s Material designation, such as 316 or 304/304. The first item indicates the makeup of the inner liner, while the second half indicates the material content of the outer wall, if stainless. If aluminized steel outer (Alum), the part number indicates inner material only.
4. Then, following a long dash, the product’s Code name is listed, such as AG30, JY, or MVT. If the product is air insulated, the product identification ends with this code.

5. Finally, when a product is fiber insulated, a designation is added at the end to indicate Insulation Thickness. C1 means a thickness of 1-inch; C2, 2-inches; Z3, 3-inches; Z4/C4 4 inches.

(For Product Code listings, refer to page 2.)

(For comparison, see photos above.)

(Alternate material and custom outer wall treatments are also available, please contact customer service for information.)

Thus, the Ordered Part Number for a 30-inch Adjustable Pipe, with a 6-inch I.D., made of 304 Stainless Steel inner and aluminized steel outer, packed with 2-inch ceramic fiber insulation, is listed:

6IVSI304- AG30C2*

* Note: For products with reduction or increaser parts, the part number changes as follows:

MT and JL - Diameter of Body listed in front of Model VSI or IVSI.
Diameter of Snout listed in front of Code designation.

Example - For a Manifold Tee with a 42" dia. Body and 30" dia. Snout:

42VSI304-30MT

OT and OS - Smaller diameter listed first (before Model designation)
Larger diameter listed before Code designation

Example - For a Tapered Increaser with an 8" to 16"dia. Body:

8VSI304-16OT

Overlapping
Vee Band

Code:
VB

Vee Band for connecting inner 1/2" rolled flanges. Capable of holding 60" w.c. of pressure when properly installed.



Materials Available:
All Stainless Construction

- Notes:
- 1. VB's are a one or two-piece design. Included with pipe sections.
 - 2. Model VSI part used for all IVSI applications.

Alignment
Sleeve

Code:
AS

Used in centering adjacent components in horizontal and vertical orientations to facilitate installation.



Materials Available:
All Stainless Construction

- Notes:
- 1. AS included with pipe sections.

Channel
Band

Code:
CB

Used to seal the Outer Jackets of two adjoining components.



(CB height is 4 3/4")

Materials Available:	
Aluminized Steel	316

- Notes:
- 1. Ceramic fiber insulation provided for IVSI models with the CB and HCB.

Half Channel
Band

Code:
HCB

Used to seal the Outer Jackets of two adjoining components when the VB must remain open (such as PA's).



Materials Available:	
Aluminized Steel	316

- Notes:
- 1. Ceramic fiber insulation provided for IVSI models with the CB and HCB.

Low Temperature Sealant
Code: P600

High Temperature Sealant
Code: P2000

High Efficiency Condensing Sealant
Code: SGV550

Depending upon application, appropriate sealants are applied to the VB before connecting two Inner Pipes at installation.

As designated, P600 Sealant is for 600° F. maximum flue gas temperatures, and also for exterior weathering of pipe, while P2000 is capable for flue gases up to 2,000° F (Not to be used externally); SGV550 is for 550° F maximum flue gas temperature for all SGV applications.

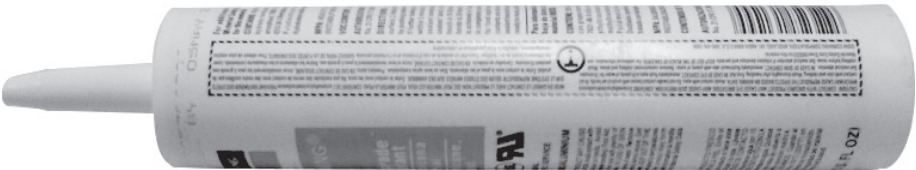

Sealant Coverage	
Expected Number of Joints Sealed Per Tube	
Inner Dia. (inches)	P600 P2000 SGV550
5/6	5
8/10	5
12	4
14/16	4
18/20	3
22/24	3
26/28	2
30/32	2
36	1
42/48	.5

Quick and Easy Component Assembly

For all AMPCO pipe and fittings, the flange-to-flange inner pipe joints are identical for each pipe inside diameter.

Temperature of gases carried in the system determines the proper sealant used.*

Quick and easy component assembly using only standard tools.

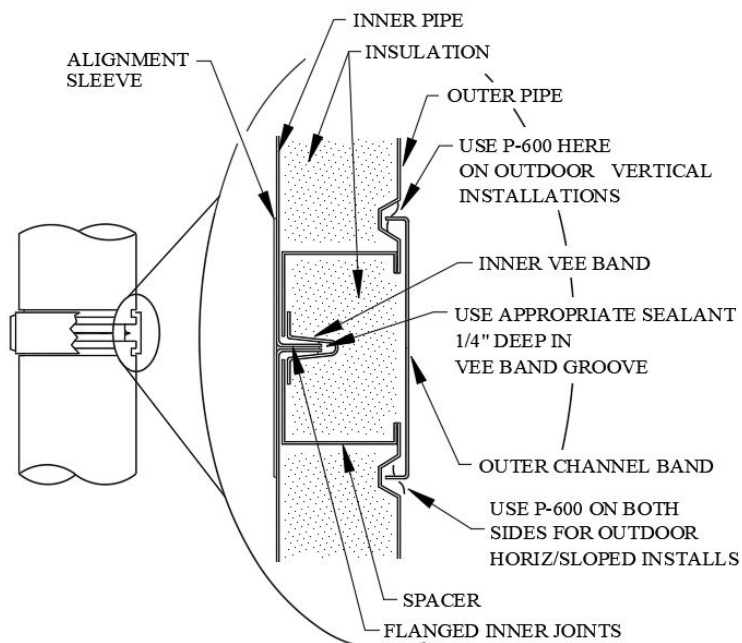

*Illustrations shown are for reference only.

(Refer to Installation Instructions for detailed sealant application and use.)



Straight Length Component

Used horizontally and vertically – array of components available, designed to make a complete installation simple and quick.



Channel Band Assembly

Used to enclose the inner-wall conduit and component locking system, providing a clean finished appearance for the overall installation; factory-assembled components with a one-piece assembly facilitates field installation.



V-Band Component Locking Assembly

Used to secure adjacent components for a strong secure joint; factory-assembled components with a one-piece assembly facilitates field installation.



Alignment Sleeve

Used to provide easier and quicker component assembly in centering adjacent components in the horizontal and vertical orientations and provides a backing for sealant applied to the flange keeping it in the intended location, along with adding strength to the overall joint connection.



Straight Length Component

Used horizontally and vertically – array of components available, designed to make a complete installation simple and quick.

Finished Assembly

Completed installation provides a strong, uniformly aligned pressure stack.



Straight Pipe Lengths

Codes:

59, 42, 30, 18

Standard pipe lengths for all AMPCO exhaust systems.



Materials Available:

304/Alum	316/Alum	304/304	316/316
----------	----------	---------	---------

Note: Alum is aluminized steel

- 59.13" lengths available in:
 - 6-24" inner diameter for VSI and IVSIC1
 - 6-22" inner diameter for IVSIC2
 - 6-20" inner diameter for Z3
 - 6-18" inner diameter for IVSIC4 and Z4
- 42" lengths available in:
 - 5-42" inner diameter for VSI and IVSIC1
 - 5-40" inner diameter for IVSIC2
 - 5-36" inner diameter for IVSIC4, Z3 and Z4
- 18" & 30" lengths available in:
 - 5-48" Inner diameter for VSI, IVSIC1, C2, C4
 - 5-36" Inner diameter for IVSIZ3 and Z4

Ordered Part Includes:

Straight Pipe Length, plus one VB, one AS, and one CB.

Notes:

1. Special pipe lengths from 6" to 59.13" available upon special request.

2. K Factors

(Where L = pipe length in feet and D = pipe diameter in inches)

- a. For Boiler Stacks and Chimneys:

$$K = 0.30 \frac{L}{D}$$

- b. For Diesel and Turbine Exhausts and Grease Ducts:

$$K = 0.25 \frac{L}{D}$$

e.g. for 50 feet of 10 inch diameter pipe

$$K = 0.25 \frac{50}{10} = 1.25$$

Adjustable Pipe Lengths

Codes:

AG30, AG18

Fills odd dimensions and compensates for expansion between two fixed points on low pressure applications.

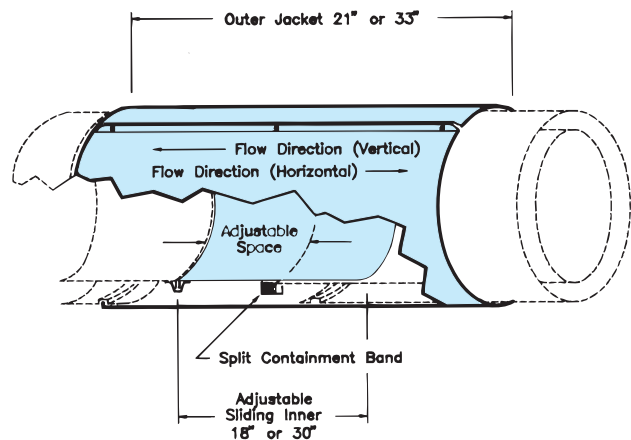

Materials Available:

304/Alum	316/Alum	304/304	316/316
----------	----------	---------	---------

Note: Alum is aluminized steel

Ordered Part Includes:

Pipe, plus one 30" or 18" inner Slip Section, one TSU, one Packing Seal, one two-piece Compression Band, one two-piece Containment Ring, one two-piece Outer Jacket, and one VB.
Ceramic fiber insulation provided for IVSI models.

Notes:

1. Minimum installed length is 4".
2. AG18 not available for 28" diameter and above.
3. Maximum installed space is when the inner slip section protrudes at least 1/2 pipe diameter into the adjacent pipe.
4. Flow Resistance Factor (K) is the same as insulated pipe lengths.

Lined Bellows Joint

Code:
BJ

Provides a pressure tight expansion joint for engine exhaust and other high pressure applications.

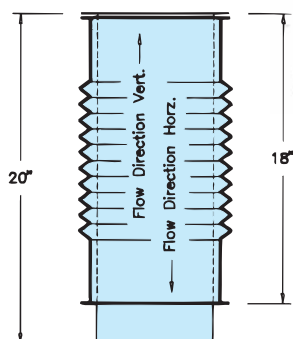

Materials Available:

316/Alum	316/316
----------	---------

Note: Alum is aluminized steel

Ordered Part Includes:

BJ, plus one Liner, one Outer Jacket, and one VB.

Ceramic fiber insulation provided for IVSI models.

Notes:

1. Optional to standard adjustable pipe lengths.
2. Liner protects Bellows but limits movement to liner expansions only.
3. Flow Resistance Factor (K) is the same as insulated pipe.

Variable Pipe Lengths

Codes:
VL30, VL18

Fills odd dimensions between standard lengths. (Not used to compensate for thermal expansion.)

- VL30 fills 4" - 26" space.
- VL18 fills 4" - 14" space.

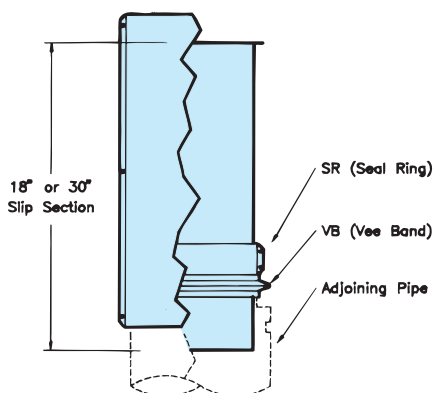

Materials Available:

304/Alum	316/Alum	304/304	316/316
----------	----------	---------	---------

Note: Alum is aluminized steel

Ordered Part Includes:

VL30 or VL18, plus one 30" or 18" Inner Slip Section, one two-piece Outer Jacket, one Custom SR, and one VB. Ceramic fiber insulation provided for IVSI models.

Notes:

1. The Custom SR is sealed with supplied sealant, not allowing the VL to compensate for expansion.
2. Flow Resistance Factor (K) is the same as insulated pipe.

90° Manifold Tee

Code:
MT

Joins vertical and horizontal sections to affect a change of direction. Also provides for connection of drain or inspection fittings.

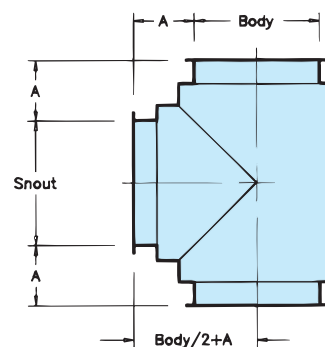

Dimension A			
VSI/IVSI-C1	IVSI-C2	IVSI-Z3	IVSI-C4/IVSI-Z4
4"	5"	6"	7"

Materials Available:

304/Alum	316/Alum	304/304	316/316
----------	----------	---------	---------

Note: Alum is aluminized steel

Ordered Part Includes:

MT, plus one VB for the body diameter, one VB for the snout diameter, one AS for the body diameter, and one CB for the body diameter.

Notes:

1. Use TCN/NTAC for clean out or inspection, or TC for drain at base of vertical stack. (NTAC is for low pressure systems only)
2. Snout available in any standard diameter equal to or smaller than the body diameter.

Combination Lateral Tee

Code:
CL

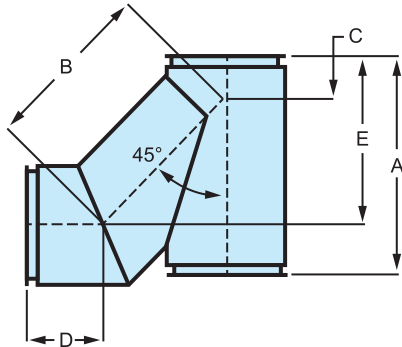

Materials Available:

304/Alum	316/Alum	304/304	316/316
----------	----------	---------	---------

Note: Alum is aluminized steel

Ordered Part Includes:

CL, plus one VB for the body diameter, one VB for the snout diameter, one AS for the body diameter, and one CB for the body diameter.

Notes:

1. K = 0.55 Flow Resistance Factor

Product				Dimensions						
(Pipe I. D.)				(Inches)						
VSI/IVSI	IVSI	IVSI	IVSI	A	B	C	D	E	(O. D.)	
C1	C2	Z3	C4/Z4							
5	—	—	—	19-1/2	13-3/4	5-3/4	8-1/2	15-3/8	7	
6	5	—	—	19-1/2	13-3/4	5-3/4	8-1/2	15-3/8	8/9	
8	6	—	—	22-7/8	16-5/8	6-1/4	8-15/16	18	10	
—	—	5	—	23-1/2	17-3/4	5-3/4	9-1/8	18-5/16	11	
10	8	6	—	24-1/16	19	5-1/16	9-5/16	18-1/2	12	
—	—	—	5	26-15/16	21-7/16	5-1/2	10-1/4	20-9/16	13	
12	10	8	6	26-15/16	21-7/16	5-1/2	10-1/4	20-9/16	14	
14	12	10	8	29-3/4	23-7/8	5-7/8	10-11/16	22-3/4	16	
16	14	12	10	32-9/16	26-1/4	6-5/16	11-5/8	24-7/8	18	
18	16	14	12	35-3/8	28-3/4	6-3/4	12-1/16	27	20	
20	18	16	14	38-3/16	31-1/16	7-1/8	13	29-1/16	22	
22	20	18	16	43-7/8	35-7/8	8	13-5/16	33-3/8	24	
24	22	20	18	43-7/8	35-7/8	8	14-5/16	33-3/8	26	
26	24	22	20	49-9/16	40-3/4	8-13/16	14-7/8	37-5/8	28	
28	26	24	22	49-9/16	40-3/4	8-13/16	15-11/16	37-5/8	30	
30	28	26	24	55-3/16	45-9/16	9-5/8	16-1/4	41-13/16	32	
32	30	28	26	55-3/16	45-9/16	9-5/8	17	41-13/16	34	
—	32	30	28	60-13/16	50-3/8	10-7/16	17-9/16	46-1/16	36	
36	—	32	30	60-13/16	50-3/8	10-7/16	18-3/8	46-1/16	38	
—	36	—	32	69-15/16	58-1/4	11-3/4	18-7/8	52-15/16	40	
—	—	36	—	69-15/16	58-1/4	11-3/4	19-5/16	52-15/16	42	
42	—	—	36	69-15/16	58-1/4	11-3/4	19-11/16	52-9/16	44	
—	42	—	—	79-3/16	66-1/8	13	20-1/8	59-11/16	46	
48	—	—	42	79-3/16	66-1/8	13	21-7/16	59-11/16	50	
—	48	—	—	88-5/8	74-1/4	14-7/16	21-7/16	64-1/2	52	
—	—	—	48	88-5/8	74-1/4	14-7/16	21-7/16	66-15/16	56	

45° Lateral Tee

Code:
JL

Provides a low resistance entry into manifolds. Combine with EL45 for low resistance 90° direction change.

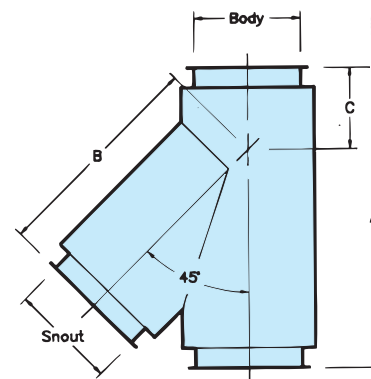

Materials Available:

304/Alum	316/Alum	304/304	316/316
----------	----------	---------	---------

Note: Alum is aluminized steel

Ordered Part

Includes:

JL, plus one VB for the body diameter, one VB for the snout diameter, one AS for the body diameter, and one CB for the body diameter.

Notes:

- Snout available in any standard diameter equal to or smaller than the body diameter.
- K = 0.4 Flow Resistance Factor

Product				Dimensions						
(Pipe I. D.)				(Inches)						
VSI/IVSI	IVSI	IVSI	IVSI	A	B	C	(O. D.)			
C1	C2	Z3	C4/Z4							
5	—	—	—	19-1/2	13-3/4	5-3/4	7			
6	5	—	—	19-1/2	13-3/4	5-3/4	8/9			
8	6	—	—	22-7/8	16-5/8	6-1/4	10			
—	—	5	—	23-1/2	17-3/4	5-3/4	11			
10	8	6	—	24-1/16	19	5-1/16	12			
—	—	—	5	26-15/16	21-7/16	5-1/2	13			
12	10	8	6	26-15/16	21-7/16	5-1/2	14			
14	12	10	8	29-3/4	23-7/8	5-7/8	16			
16	14	12	10	32-9/16	26-1/4	6-5/16	18			
18	16	14	12	35-3/8	28-3/4	6-3/4	20			
20	18	16	14	38-3/16	31-1/16	7-1/8	22			
22	20	18	16	43-7/8	35-7/8	8	24			
24	22	20	18	43-7/8	35-7/8	8	26			
26	24	22	20	49-9/16	40-3/4	8-13/16	28			
28	26	24	22	49-9/16	40-3/4	8-13/16	30			
30	28	26	24	55-3/16	45-9/16	9-5/8	32			
32	30	28	26	55-3/16	45-9/16	9-5/8	34			
—	32	30	28	60-13/16	50-3/8	10-7/16	36			
36	—	32	30	60-13/16	50-3/8	10-7/16	38			
—	36	—	32	69-15/16	58-1/4	11-3/4	40			
—	—	36	—	69-15/16	58-1/4	11-3/4	42			
42	—	—	36	69-15/16	58-1/4	11-3/4	44			
—	42	—	—	79-3/16	66-1/8	13	46			
48	—	—	42	79-3/16	66-1/8	13	50			
—	48	—	—	88-5/8	74-1/4	14-7/16	52			
—	—	—	48	88-5/8	74-1/4	14-7/16	56			

90° WYE

Code:
JY

Provides low pressure drop for joining appliances in the horizontal and vertical position.

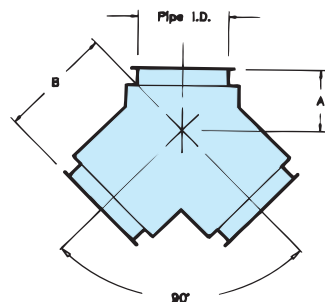

Materials Available:

304/Alum	316/Alum	304/304	316/316
----------	----------	---------	---------

Note: Alum is aluminized steel

Ordered Part

Includes:

JY, plus two VB's, one AS, and one CB.

Notes:

1. All openings are the same diameter.
2. Can be used with TCN/NTAC to provide a single clean out toward each 90° direction change.
3. Use OT or OS as needed for smaller branch connections.
4. K = 0.6 Flow Resistance Factor

Product					Dimensions		
(Pipe I. D.)					(Inches)		
VSI/IVSI C1	IVSI C2	IVSI Z3	IVSI C4/Z4		A	B	(O. D.)
5	—	—	—		4-5/8	9	7
6	5	—	—		4-5/8	9	8/9
8	6	—	—		5-1/16	10	10
—	—	5	—		5	11	11
10	8	6	—		5	11	12
—	—	—	5		5-1/2	12	13
12	10	8	6		5-1/2	12	14
14	12	10	8		5-7/8	13	16
16	14	12	10		6-3/8	14	18
18	16	14	12		6-5/8	15	20
20	18	16	14		7-1/8	17	22
22	20	18	16		8	19	24
24	22	20	18		8	19	26
26	24	22	20		8-3/4	22	28
28	26	24	22		8-3/4	22	30
30	28	26	24		9-5/8	24	32
32	30	28	26		9-5/8	24	34
—	32	30	28		10-1/2	27	36
36	—	32	30		10-1/2	27	38
—	36	—	32		11-3/4	31	40
—	—	36	—		11-3/4	31	42
42	—	—	36		11-3/4	31	44
—	42	—	—		13	34	46
48	—	—	42		13	34	50
—	48	—	—		14-1/4	38	52
—	—	—	48		14-1/4	38	56

Drain Tee Cap

Code:
TC

Provides a drain at the base of a vertical chimney when connected to the MT or JL.

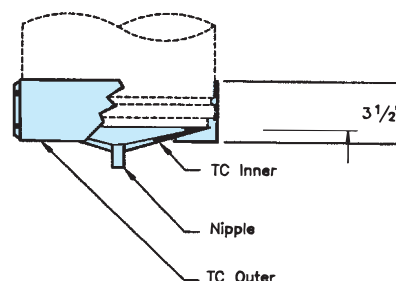

Materials Available:

304/Alum	316/Alum	304/304	316/316
----------	----------	---------	---------

Note: Alum is aluminized steel

Ordered Part Includes:

TC, plus one 1" N.P.T. Nipple (5"-20" sizes), or 2" N.P.T. Nipple (22"-48" sizes), one Inner Section, one Outer Jacket, and one VB. Ceramic fiber insulation provided for IVSI models.

Cleanout Tee Cap

Code:
TCN

Provides for cleanout at end of manifold when connected to MT or JL.

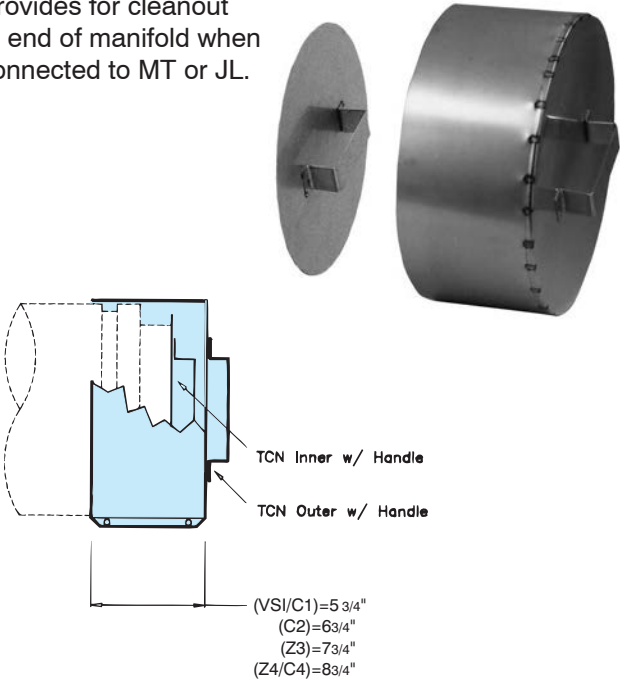

Materials Available:

304/Alum	316/Alum	304/304	316/316
----------	----------	---------	---------

Note: Alum is aluminized steel

Ordered Part Includes:

TCN, plus one Inner Section (with handle), one Outer Jacket (with handle), and one VB.
Ceramic fiber insulation provided for IVSI models

Also available as a No Tool Access Cap (NTAC), good for use with grease duct. See pg. 29.

15° Elbow

Code:
EL15

This two-piece Elbow can establish many different degrees when combined with other standard Elbows.

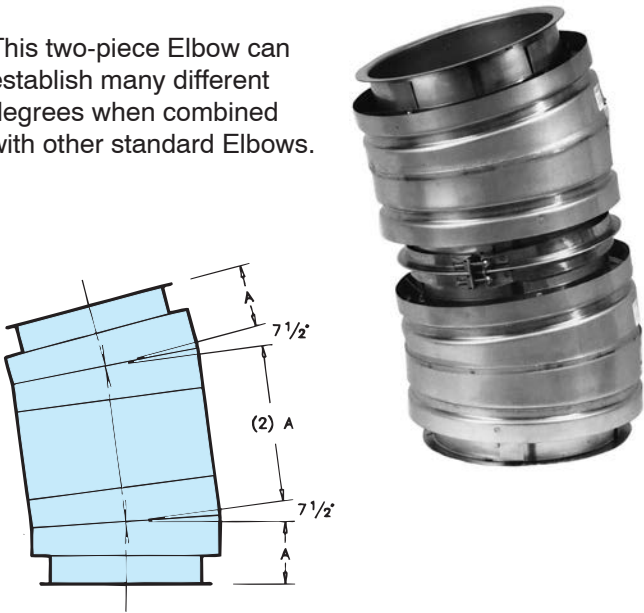

Materials Available:

304/Alum	316/Alum	304/304	316/316
----------	----------	---------	---------

Note: Alum is aluminized steel

Ordered Part Includes:

Two 7 1/2 Deg. Elbows, plus two VB's, two AS's, and two CB's.

Notes:

1. K = 0.06 Flow Resistance Factor

				Dimensions	
(Pipe I. D.)				(Inches)	
VSI/IVSI C1	IVSI C2	IVSI Z3	IVSI C4/Z4	A	(O. D.)
5	—	—	—	4-3/16	7
6	5	—	—	4-3/16	8/9
8	6	—	—	4-1/4	10
—	—	5	—	4-5/16	11
10	8	6	—	4-5/16	12
—	—	—	5	4-7/16	13
12	10	8	6	4-7/16	14
14	12	10	8	4-1/2	16
16	14	12	10	4-9/16	18
18	16	14	12	4-5/8	20
20	18	16	14	4-11/16	22
22	20	18	16	4-3/4	24
24	22	20	18	4-13/16	26
26	24	22	20	4-7/8	28
28	26	24	22	4-15/16	30
30	28	26	24	5	32
32	30	28	26	5-1/16	34
—	32	30	28	5-1/8	36
36	—	32	30	5-3/16	38
—	36	—	32	5-5/16	40
—	—	36	—	5-3/8	42
42	—	—	36	5-3/8	44
—	42	—	—	5-1/2	46
48	—	—	42	5-9/16	50
—	48	—	—	5-9/16	52
—	—	—	48	5-9/16	56

30° Elbow

Code:
EL30

Used for a vertical or horizontal direction change of 30°.

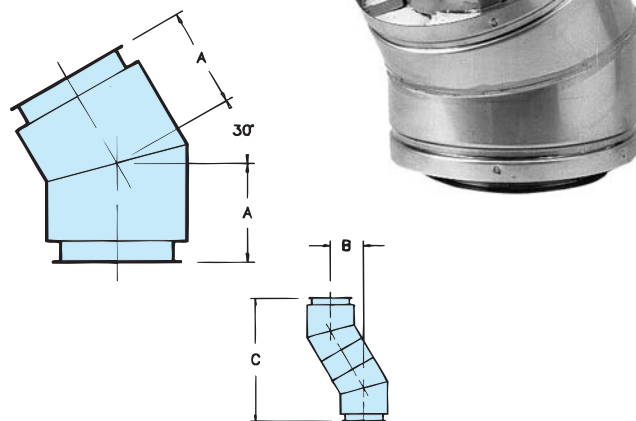

Materials Available:

304/Alum	316/Alum	304/304	316/316
----------	----------	---------	---------

Note: Alum is aluminized steel

Ordered Part Includes:
EL30, plus one VB, one AS, and one CB.

Notes:
1. K = 0.12 Flow Resistance Factor

Product				Dimensions			
(Pipe I. D.)				(Inches)			
VSI/IVSI C1	IVSI C2	IVSI Z3	IVSI C4/Z4	A	B	C	(O. D.)
5	—	—	—	6-1/8	6-1/8	22-3/8	7
6	5	—	—	6-1/8	6-1/8	22-7/8	8/9
8	6	—	—	6-3/8	6-3/8	23-7/8	10
—	—	5	—	6-9/16	6-9/16	24-3/8	11
10	8	6	—	6-11/16	6-11/16	24-7/8	12
—	—	—	5	7-5/16	7-5/16	27-1/4	13
12	10	8	6	7-5/16	7-5/16	27-1/4	14
14	12	10	8	7-7/8	7-7/8	29-5/8	16
16	14	12	10	8-1/4	8-1/4	30-5/8	18
18	16	14	12	8-5/8	8-5/8	31-5/8	20
20	18	16	14	9-1/8	9-1/8	34-1/8	22
22	20	18	16	9-3/8	9-3/8	35	24
24	22	20	18	10-1/16	10-1/16	37-1/2	26
26	24	22	20	10-5/16	10-5/16	38-1/2	28
28	26	24	22	11	11	40-7/8	30
30	28	26	24	11-1/4	11-1/4	41-7/8	32
32	30	28	26	11-7/8	11-7/8	44-3/8	34
—	32	30	28	12-3/16	12-3/16	45-3/8	36
36	—	32	30	12-7/8	12-3/4	47-3/4	38
—	36	—	32	13-1/8	13-1/8	48-7/8	40
—	—	36	—	13-9/16	13-9/16	50-5/8	42
42	—	—	36	14	14	52-1/2	44
—	42	—	—	14-1/4	14-1/4	53-1/8	46
48	—	—	42	14-3/16	14-3/16	56-7/16	50
—	48	—	—	15-5/16	15-5/16	57-1/8	52
—	—	—	48	15-5/16	15-5/16	57-1/8	56

45° Elbow

Code:
EL45

Used for a vertical or horizontal direction change of 45°.

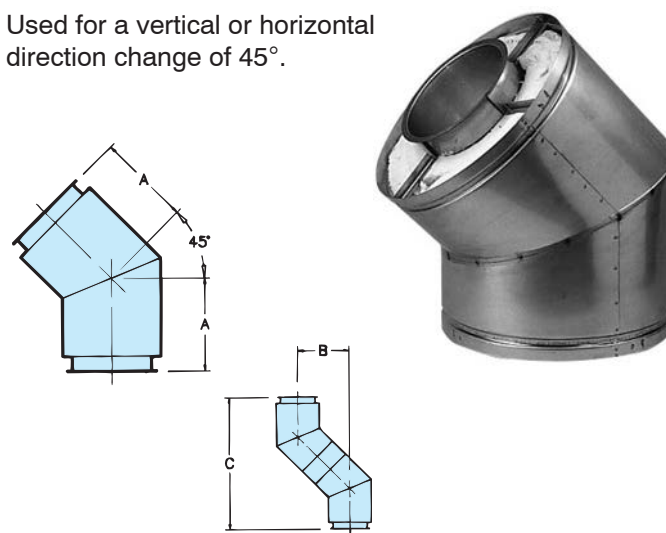

Materials Available:

304/Alum	316/Alum	304/304	316/316
----------	----------	---------	---------

Note: Alum is aluminized steel

Ordered Part Includes:
EL45, plus one VB, one AS, and one CB.

Notes:
1. K = 0.15 Flow Resistance Factor

Product				Dimensions			
(Pipe I. D.)				(Inches)			
VSI/IVSI C1	IVSI C2	IVSI Z3	IVSI C4/Z4	A	B	C	(O. D.)
5	—	—	—	8-1/2	12	29	7
6	5	—	—	8-1/2	12	29	8/9
8	6	—	—	8-15/16	12-5/8	30-7/16	10
—	—	5	—	9-1/8	12-7/8	31-1/8	11
10	8	6	—	9-5/16	13-3/16	31-7/8	12
—	—	—	5	10-1/4	14-1/2	35	13
12	10	8	6	10-1/4	14-1/2	36	14
14	12	10	8	10-11/16	15-1/8	36-1/2	16
16	14	12	10	11-5/8	16-7/16	39-5/8	18
18	16	14	12	12-1/16	17-1/16	41-1/8	20
20	18	16	14	13	18-3/8	44-1/4	22
22	20	18	16	13-5/16	18-13/16	45-1/2	24
24	22	20	18	14-5/16	20-1/4	48-1/8	26
26	24	22	20	14-7/8	21-1/16	50-7/8	28
28	26	24	22	15-11/16	22-3/16	53-1/2	30
30	28	26	24	16-1/4	22-15/16	53-3/8	32
32	30	28	26	17	24	58	34
—	32	30	28	17-9/16	24-3/4	59-7/8	36
36	—	32	30	18-3/8	25-15/16	62-5/8	38
—	36	—	32	18-7/8	26-11/16	64-1/2	40
—	—	36	—	19-5/16	27-5/16	65-15/16	42
42	—	—	36	19-11/16	27-7/8	67	44
—	42	—	—	20-1/8	28-7/16	68-5/8	46
48	—	—	42	21-7/16	30-5/16	74-7/8	50
—	48	—	—	21-7/16	30-5/16	74-7/8	52
—	—	—	48	21-7/16	30-5/16	74-7/8	56

90° Elbow

Code:
EL90

Used for a vertical or horizontal direction change of 90°.

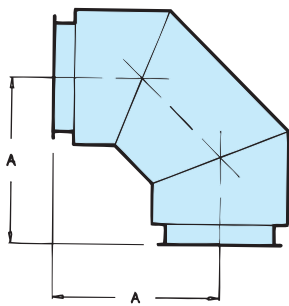

Materials Available:

304/Alum	316/Alum	304/304	316/316
----------	----------	---------	---------

Note: Alum is aluminized steel

Ordered Part Includes:
EL90, plus one VB, one AS, and one CB.

Notes:

1. $K = 0.30$ Flow Resistance Factor

Product				Dimensions	
(Pipe I. D.)				(Inches)	
VSI/IVSI	IVSI	IVSI	IVSI	A	(O. D.)
C1	C2	Z3	C4/Z4		
5	—	—	—	11-1/2	7
6	5	—	—	11-1/2	8/9
8	6	—	—	12-1/2	10
—	—	5	—	13-1/2	11
10	8	6	—	13-1/2	12
—	—	—	5	14-1/2	13
12	10	8	6	14-1/2	14
14	12	10	8	15-1/2	16
16	14	12	10	16-1/2	18
18	16	14	12	17-1/2	20
20	18	16	14	18-1/2	22
22	20	18	16	19-1/2	24
24	22	20	18	20-1/2	26
26	24	22	20	21-1/2	28
28	26	24	22	22-1/2	30
30	28	26	24	23-1/2	32
32	30	28	26	24-1/2	34
—	32	30	28	25-1/2	36
36	—	32	30	26-1/2	38
—	36	—	32	27-1/2	40
—	—	36	—	28-1/2	42
42	—	—	36	29-1/2	44
—	42	—	—	30-1/2	46
48	—	—	42	32-1/2	50
—	48	—	—	33-1/2	52
—	—	—	48	35-1/2	56

Tapered Increaser/Reducer

Code:
OT

Used when a pipe diameter change is required.

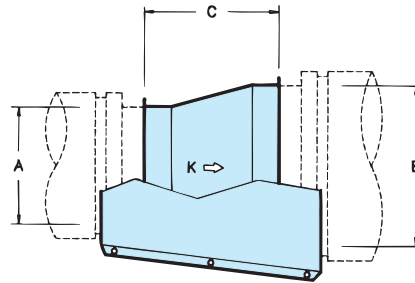

Materials Available:

304/Alum	316/Alum	304/304	316/316
----------	----------	---------	---------

Note: Alum is aluminized steel

Dimensions:

A = Smaller Diameter

B = Larger Diameter

C = Installed Length = $[(B-A) 2] + 2$ (see Note 1 below)

Example:

Installed Length for 12VSI304-180T equals $[(18-12)2] + 2 = 14$ inches.

Ordered Part Includes:

OT, plus one two-piece Outer Jacket, and one VB for smaller diameter.

Ceramic fiber insulation provided for IVSI models.

Notes:

1. Installed length shall not be greater than longest available straight pipe length (see page 10) for each diameter.
2. $K = N [1 - (A/B)^2]^2$
where $N = 0.47$ for one step OT
 $N = 0.53$ for two step OT

Step Increaser/Reducer

Code:
OS

Used when pipe diameter change is required in a small space.

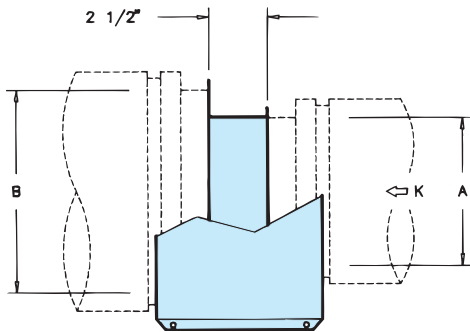

Materials Available:

316/Alum	316/316
----------	---------

Note: Alum is aluminized steel

Ordered Part Includes:

OS (Inner Stepped Pipe), plus one two-piece Outer Jacket, and one VB for the smaller diameter.
Ceramic fiber insulation provided for IPS models.

Notes:

1. This is a non-structural part; use only if OT will not fit within the allowable space.
2. $K = N [1 - (A/B)^2]^2$

Drain Section

Code:
DS

Used with open stack terminations for draining off rain water from inside vertical or horizontal flue.

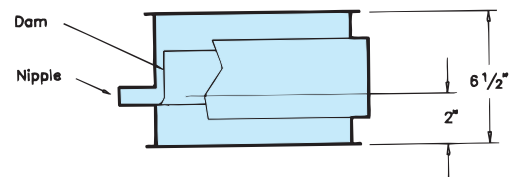

Materials Available:

304/Alum	316/Alum	304/304	316/316
----------	----------	---------	---------

Note: Alum is aluminized steel

Ordered Part Includes:

DS, plus one Drain Dam within the pipe length, one 1" Nipple, one CB, and one VB.

Notes:

1. $K = 0.25$ Flow Resistance Factor

Angle Rings

Codes:
HR & FR

Used for guiding and/or supporting horizontal installations.

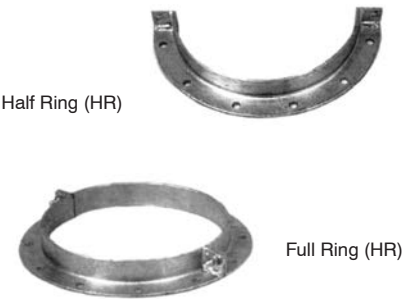

Materials Available:

Painted Steel

Notes:

1. Model VSI part used for IVSIC1 applications.

Product				Dimensions (Inches) HR				
(Pipe I. D.)								
VSI/IVSI	IVSI	IVSI	IVSI	Bolt	I.D.	No of	Size	Angle
C1	C2	Z3	C4/Z4	Hole	of	Holes	of	of
				Circle	Ring	(HR)	Angles	Holes
5	-	-	-	9	7-1/8	6	(1)	45
6	5	-	-	10	8-1/8	6	(1)	45
8	6	-	-	12	10-1/8	6	(1)	45
-	-	5	-	13	11-1/8	6	(1)	45
10	8	6	-	14	12-1/8	6	(1)	45
-	-	-	5	15	13-1/8	6	(1)	45
12	10	8	6	16	14-1/8	6	(1)	45
14	12	10	8	18	16-1/8	6	(1)	45
16	14	12	10	20	18-1/8	6	(1)	45
18	16	14	12	22	20-1/8	6	(1)	45
20	18	16	14	24	22-1/8	6	(1)	45
22	20	18	16	26	24-1/8	10	(2)	22.5
24	22	20	18	28	26-1/8	10	(2)	22.5
26	24	22	20	30	28-1/8	10	(2)	22.5
28	26	24	22	32	30-1/8	10	(2)	22.5
30	28	26	24	34	32-1/8	10	(2)	22.5
32	30	28	26	36	34-1/8	10	(2)	22.5
-	32	30	28	38	36-1/8	10	(2)	22.5
36	-	32	30	40	38-1/8	10	(2)	22.5
-	36	-	32	42	40-1/8	10	(2)	22.5
-	-	36	-	44	42-1/8	10	(2)	22.5
42	-	-	36	46	44-1/8	10	(2)	22.5
-	42	-	-	48	48-1/8	10	(2)	22.5
48	-	-	42	52	50-1/8	10	(2)	22.5
-	48	-	-	54	62-1/8	10	(2)	22.5
-	-	-	48	58	66-1/8	10	(2)	22.5

- (1) Size of Angles = 1 1/2 x 1 1/2 x 3/16
(2) Size of Angles = 2 x 2 x 3/16

Plate Support Assembly

Code:
PA

Used for supporting the load of the stack, and as a fixed point anchor near fittings.

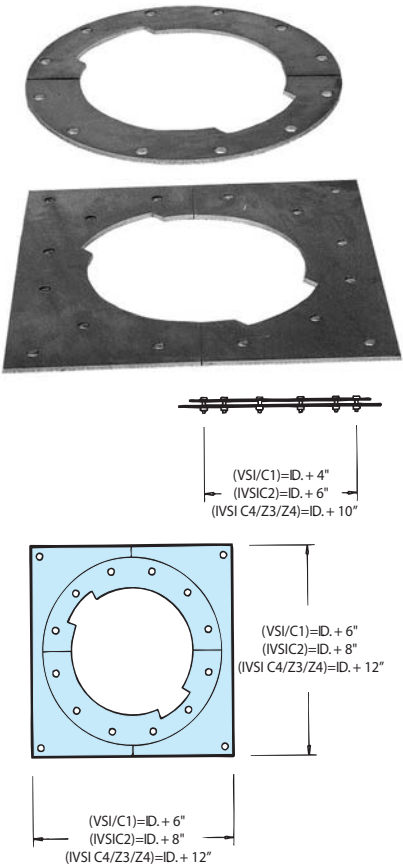

Materials Available:

Painted Steel

Ordered Part Includes:

Split (square) plate, one CF, two HCB's and hardware.

Plate Thickness:

0.188" for sizes 6" through 20" diameters
0.250" for sizes 22" through 36" diameters
0.375" for sizes 42" through 48" diameters

Notes:

- Two 316 Stainless Steel HCB's are provided for stainless steel outer projects.
- PA plate fabricated from Stainless Steel is available upon special request for an additional cost; allow additional time for manufacturing.

Wall Support Assembly

Code:
WA

"Limited" support assembly with factory supplied bracing.

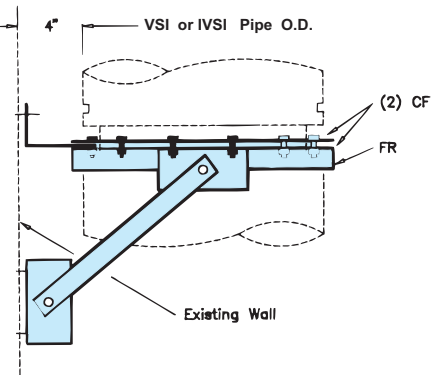

Materials Available:

Painted Steel

Ordered Part Includes:

One FR, two CF's, two HCB's, five brackets, two struts, and all hardware except connection at wall.

Notes:

- Assembly will maintain a 4" clearance between pipe O.D. and supporting structure.
- WA fabricated from Stainless Steel is available upon special request for an additional cost; allow additional time for manufacturing.

Wall Guide Assembly

Code:
WG

Same use as FR, but with factory-supplied bracing.

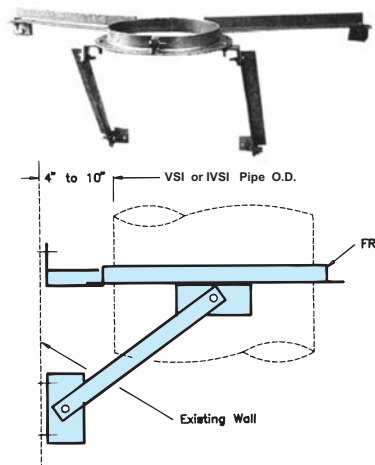

Materials Available:

Painted Steel

Ordered Part Includes:

One FR, four struts, and six brackets.

Notes:

1. Assembly will maintain a 4" to 10" clearance between pipe O.D. and supporting structure.
2. Model VSI part used for IVSIC1 applications.

Support Strap

Code:
SS

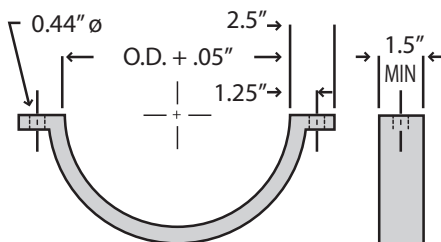

Materials Available:

Painted Steel

Notes:

Available in 5 through 26" VSI only.
0.188" Thick Hot Rolled Steel

Floor Guide Assembly

Code:
FG

Same use as FR, but with factory-supplied bracing for use at floor level.

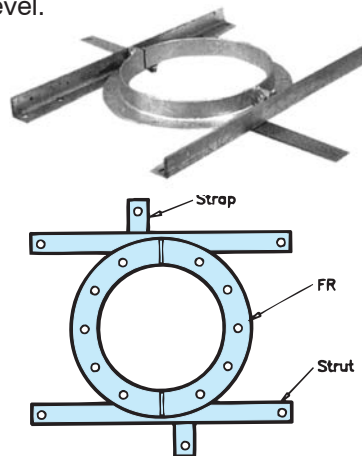

Materials Available:

Painted Steel

Ordered Part Includes:

One FR, two struts, and two straps.

Notes:

1. Maximum hole through floor should not exceed the pipe O.D. plus 8".
2. Model VSI part used for IVSIC1 applications.

Pipe I. D. (Inches)				Material (Inches)	
VSI/IVSI	IVSI	IVSI	IVSI	Strut Length	Strut Size
C1	C2	Z3	C4/Z4		
5	—	—	—	17-1/2	(1)
6	—	—	—	18	(1)
—	5	—	—	19-1/2	(1)
8	6	—	—	21	(1)
—	—	5	—	21-1/2	(1)
—	—	—	5	22-1/2	(1)
10	8	6	—	24	(1)
12	10	8	6	27	(1)
14	12	10	8	29	(2)
16	14	12	10	30	(2)
18	16	14	12	32	(2)
20	18	16	14	33	(2)
22	20	18	16	34-1/2	(3)
24	22	20	18	36	(3)
26	24	22	20	37	(3)
28	26	24	22	38	(3)
30	28	26	24	39-1/2	(3)
32	30	28	26	41	(3)
—	32	30	28	42-1/2	(3)
36	—	32	30	44	(3)
—	36	—	32	46	(3)
—	—	36	—	47	(3)
42	—	—	—	48	(3)
—	42	—	36	50	(3)
—	—	—	42	52	(3)
48	—	—	—	53	(3)
—	48	—	—	54	(3)
—	—	—	48	58	(3)

(1) Steel Angle = 1-1/2 x 1-1/2 x 3/16

(2) Steel Angle = 1-3/4 x 1-3/4 x 3/16

(3) Steel Angle = 2 x 2 x 3/16

Flanged Boiler Kit

Code:
BK

Used to transition to a flanged appliance. Features 24 connection slots to mate 4, 6, 8 or 12 bolt hole patterns.

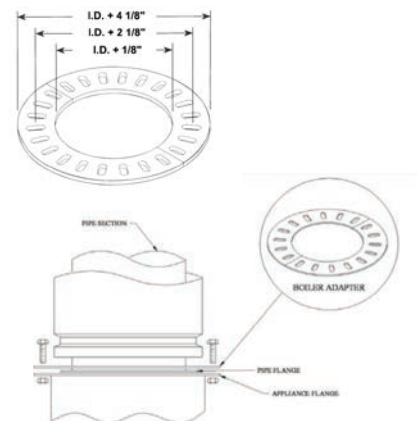

Materials Available:

Painted Steel

24 Holes .375 x 1.0 at 15 degrees.
Constructed of 1/4" hot-rolled steel.

Ordered Part Includes:

Two Half Boiler Adapter Flange Plates. Order HCB's separately if needed.

Notes:

1. Model VSI part used for all IVSI applications.

Seal Ring

Code:
SR

Used for non-welded attachment to appliances having an unflanged or collar outlet.

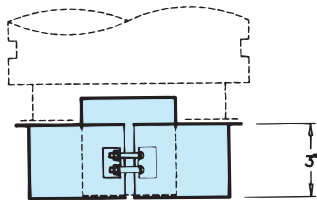
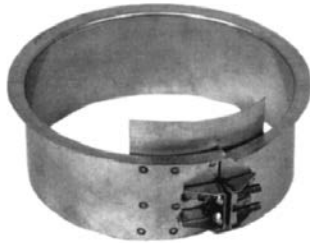

Materials Available:

304/Alum	316/Alum	304/304	316/316
----------	----------	---------	---------

Note: Alum is aluminized steel

Ordered Part Includes:
SR, one CB, and one VB & hardware

Notes:

1. Ceramic fiber insulation provided for IVSI models.

Flange Adapter

Code:
FD

Provides a rigid connection to a 125 lb. or 150 lb. ANSI flange.

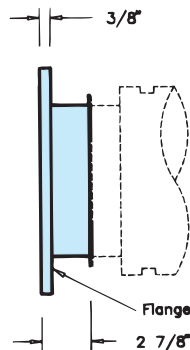

Materials Available:

316/Alum	316/316
----------	---------

Note: Alum is aluminized steel

Ordered Part Includes:
Painted Carbon Steel Flange welded to stainless TS, one special CB, and one VB.
Ceramic fiber insulation provided for IVSI models.

Product	Dimensions (Inches)			
Pipe I.D.	No of Bolts	Bolt Hole Dia.	Flange O. D.	Bolt Circle
5	8	7/8	10	8-1/2
6	8	7/8	11	9-1/2
8	8	7/8	13-1/2	11-3/4
10	12	1	16	14-1/4
12	12	1	19	17
14	12	1-1/8	21	18-3/4
16	16	1-1/8	23-1/2	21-1/4
18	16	1-1/4	25	22-3/4
20	20	1-1/4	27-1/2	25
22	20	1-3/8	29-1/2	27-1/4
24	20	1-3/8	32	29-1/2
28	28	1-3/8	36-1/2	34
30	28	1-3/8	38-1/2	36
32	28	1-5/8	41-3/4	38-1/2
36	32	1-5/8	46	42-3/4
42	36	1-5/8	53	49-1/2
48	44	1-5/8	59-1/2	56

Clamp Flange

Code:
CF

Can be used as an attachment to flanged equipment (also part of PA and WA).

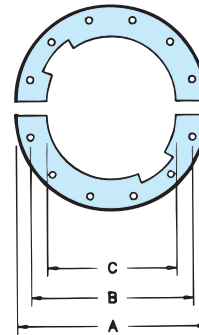

A = Flange O.D.
VSI/IVSIC1 = I.D. + 5"
C2 = I.D. + 7"
Z3/Z4/C4 = I.D. + 11"

B = Bolt Hole Circle
VSI/IVSIC1 = I.D. + 4"
C2 = I.D. + 6"
Z3/Z4/C4 = I.D. + 10"

C = Flange I.D.
VSI/IVSIC1 = I.D. + 1/2"
C2, C4
Z3, Z4

Materials Available:

Painted Steel

Ordered Part Includes:
Two half clamp flange plates.

Notes:

1. 0.139" minimum thickness for sizes 5" to 8" diameters.
2. 0.188" minimum thickness for sizes 10" through 36" diameters.
3. 0.375" minimum thickness for sizes 42" and 48" diameters.
4. Model VSI part used for IVSIC1 applications.
5. Order HCB's separately if needed.

Flanged Hood Transition

Code:
TS

Used on standard appliances such as kitchen hood exhausts. Flanged at both ends.

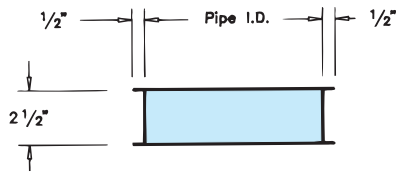

Materials Available:

304/Alum	316/Alum	304/304	316/316
----------	----------	---------	---------

Note: Alum is aluminized steel

Ordered Part Includes:

TS, plus one CB and one VB.

Ceramic fiber insulation provided with IVSI models.

Notes:

1. Can be used for welding to equipment or transitions fabricated in the field.

Unflanged Hood Transition

Code:
TSU

Used on standard appliances such as kitchen hood exhausts. Flanged at one end.

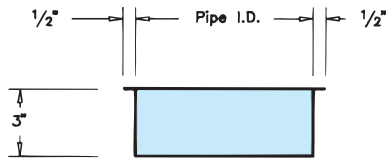

Materials Available:

304/Alum	316/Alum	304/304	316/316
----------	----------	---------	---------

Note: Alum is aluminized steel

Ordered Part Includes:

TSU, plus one CB and one VB.

Ceramic fiber insulation provided with IVSI models.

Notes:

1. Can be used for welding to equipment or transitions fabricated in the field.

Fan Adapter

Code:
FA

Used for connection to an “up-blast” kitchen exhaust fan.

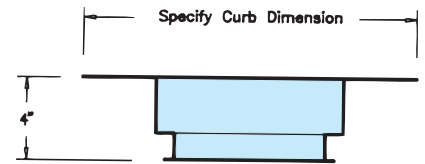

Materials Available:

304/Alum	316/Alum	304/304	316/316
----------	----------	---------	---------

Note: Alum is aluminized steel

Ordered Part Includes:

FA, plus one VB and one CB.

Notes:

1. Dimension of square plate (which is sandwiched between curb and fan housing) must be specified when ordering.

Storm Collar

Code:
SC

Used above the TF and PTF for complete weatherization above the roof.

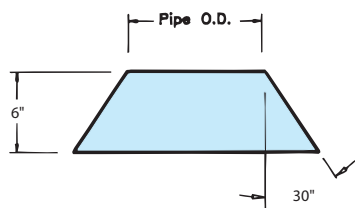

Materials Available:

Aluminized or Galvanized Steel		304	316
--------------------------------	--	-----	-----

Ordered Part Includes:
SC, plus hardware.

- Notes:
1. Requires P600 sealant when installing.
 2. Model VSI part used for IVSIC1 applications.

Tall Flashing

Code:
TF

Used in conjunction with SC for weatherization at the roof.

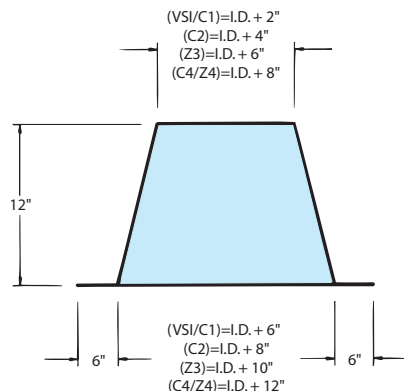

Materials Available:

Aluminized or Galvanized Steel		304	316
--------------------------------	--	-----	-----

Ordered Part Includes:
TF only.

- Notes:
1. Use limited to installations where complete roof penetration is non-combustible.
 2. Model VSI part used for IVSIC1 applications

Pitched Tall Flashing

Code:
PTF

Same function as TF, except for use on a pitched roof.

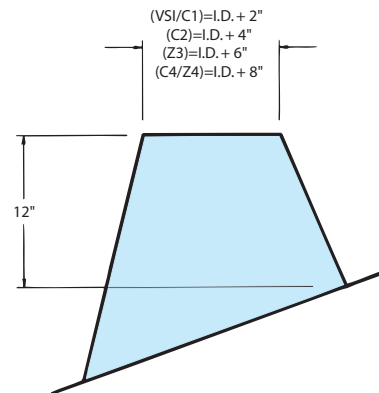

Materials Available:

Aluminized or Galvanized Steel		304	316
--------------------------------	--	-----	-----

Ordered Part Includes:
PTF only (specify pitch when ordering).

- Notes:
1. Part is non-returnable and may require extra manufacturing time.
 2. Use limited to installations where complete roof penetration is non-combustible.
 3. Model VSI part used for IVSIC1 applications.

Ventilated Thimble

Code: THB

Body part of MVT, MRS, and PVT. Also can be used by itself for a wall penetration (see installation instructions).

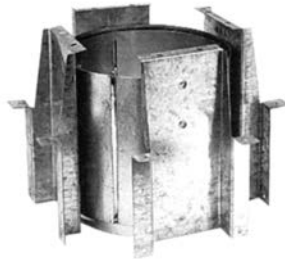
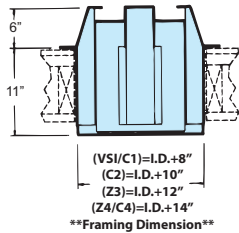

Materials Available:

Galvanized Steel

Notes:

1. Model VSI part used for IVSIC1 applications.

Ventilated Tall Flashing

Code: VTF

Encloses the THB, offers protection from weather and moisture penetration

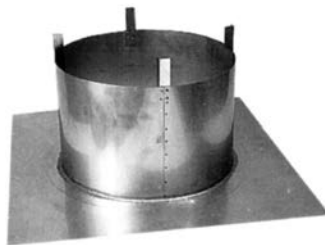
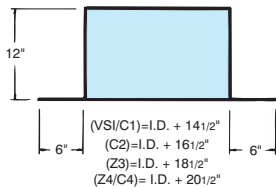

Materials Available:

Aluminized or Galvanized Steel	304	316
--------------------------------	-----	-----

Notes:

1. Model VSI part used for IVSIC1 applications.

Ventilated Storm Collar

Code: VSC

Protects the VTF from weather and moisture penetration. Also used with THB for wall penetration (see installation instructions).

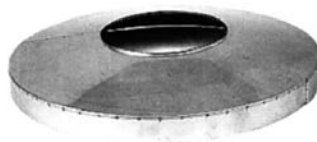
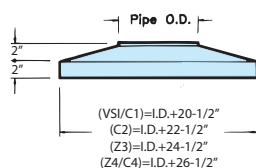

Materials Available:

Aluminized or Galvanized Steel	304	316
--------------------------------	-----	-----

Notes:

1. Model IVS part used for IVSIC1 applications.

Ventilated Roof Thimble Assembly

Code:

MVT

For use where pipe passes through a combustible roof or structure. Also guides the chimney 6" above the roof line.

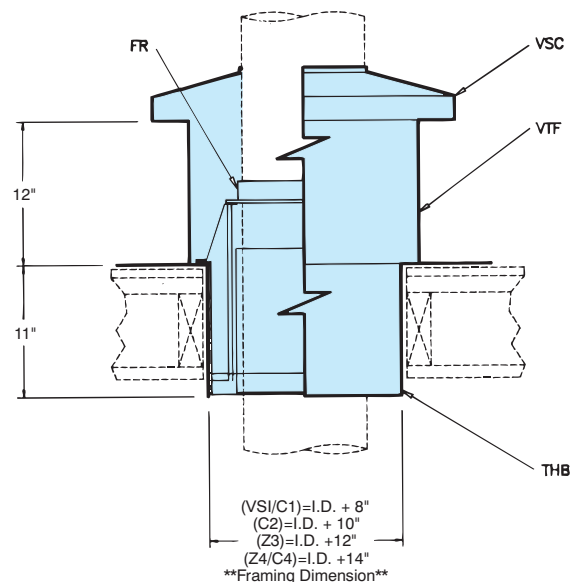
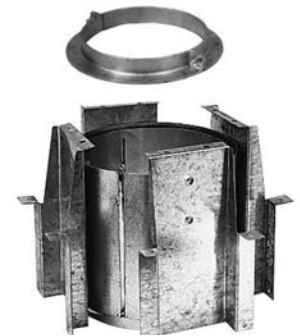
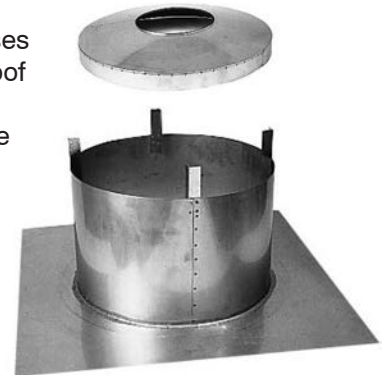

Materials Available:

Aluminized or Galvanized Steel	304	316
--------------------------------	-----	-----

Ordered Part Includes:

One THB, one FR, one VTF, and one VSC.

Notes:

1. Model VSI part used for IVSIC1 applications.

Ventilated Roof Support Assembly

Code:
MRS

For use where pipe passes through a combustible roof or structure. Supports the chimney 6" above the roof line which may require an expansion joint (AG or BJ) below the roof.

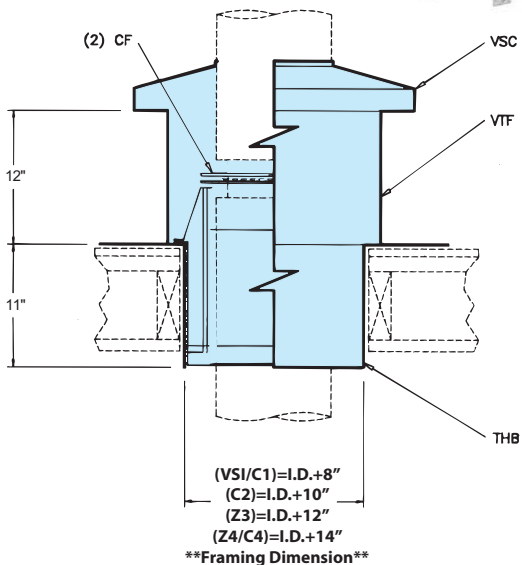
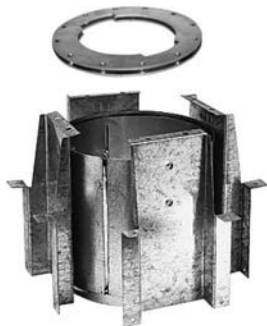
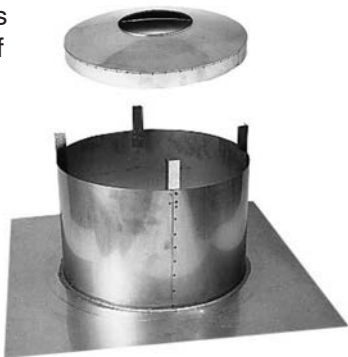

Materials Available:

Aluminized or Galvanized Steel		304	316
--------------------------------	--	-----	-----

Ordered Part Includes:
One THB, two CF's, one VTF, and one VSC.

Pitched Ventilated Roof Thimble

Code:
PVT

For use when pipe passes through a combustible pitched roof or structure. Above 24" sizes and steep pitches are not available.

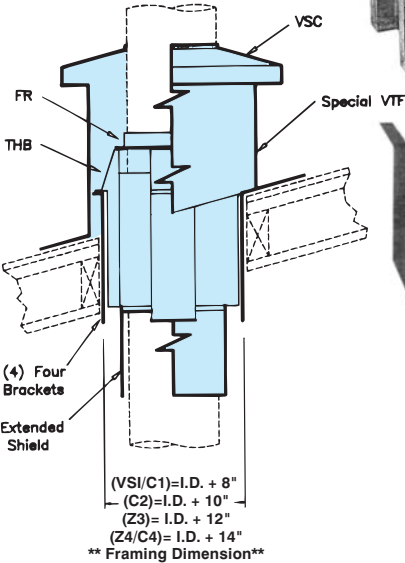
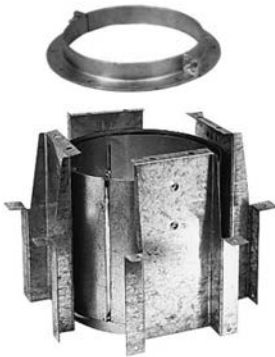

Materials Available:

Aluminized or Galvanized Steel		304	316
--------------------------------	--	-----	-----

Ordered Part Includes:
One THB, 4 brackets, extended shield, special VTF, one FR, and one VSC.

- Notes:
1. Does not provide lateral support. An additional FR is required below the roof.
 2. May require extra manufacturing time and is non-returnable.
 3. Model VSI part used for IVSIC1 applications.

Open Stack Closure Ring

Code:
CR

Protects the insulated space between standard pipe inner and outer. Requires a drain at base of stack.

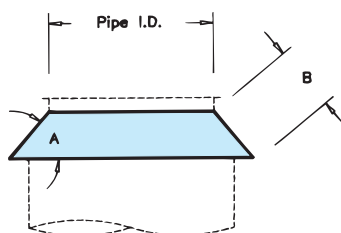
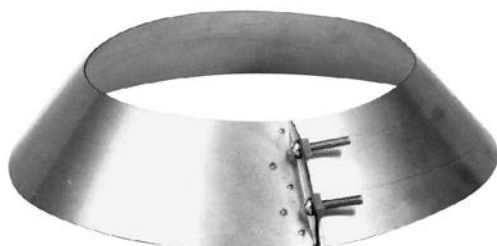

Materials Available:

316

Ordered Part Includes:
CR, plus hardware.

Notes:

1. Model VSI part used for IVSIC1 applications.

Product	Dimensions	
	A	B
VSI-C1	50°	3"
IVSI-C2	32°	3-1/2"
IVSI-Z3	25°	4-1/2"
IVSI-C4/Z4	17°	5-1/4"

Chimney Round Top

Code:
CT

Provides the greatest degree of rain protection.
Available only in 5", 6", 8", 10", 12", and 14" sizes.

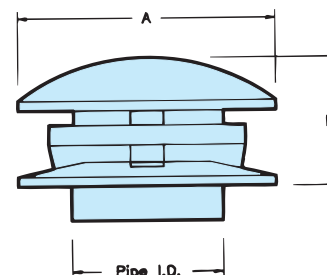

Materials Available:

430 Stainless Steel

Ordered Part Includes:
CT, plus hardware.

Notes:

1. Model VSI part used for IVSIC1 applications.
2. Part not available for IVSIC2 and IVSIC4 applications.
3. K = 0.5 Flow Resistance Factor

Product	Dimensions		
	(I.D.)	(Inches)	(O.D.)
VSI IVSI-C1 Only	A	B	
5	12	5-1/2	7
6	12	5-1/2	8/9
8	16	7	10
10	20	8-1/2	12
12	24	10	14
14	28	11-1/2	16

Stack Cap

Code:
SK

Provides partial protection with low flow resistance.
May require a drain at base of stack.

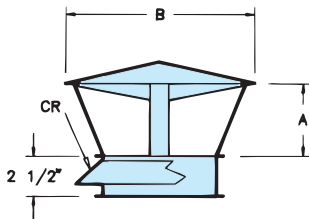

Materials Available:

304/304	316
---------	-----

Ordered Part Includes:
SK, plus one CR, one HCB and one VB.

- Notes:
- 1. Model VSI part used for IVSIC1 applications.
 - 2. $K = 0.5$ Flow Resistance Factor
 - 3. Optional Birdscreen available

Product (Pipe I.D.)	Dimensions (Inches)	
	A	B
VSI		
IVSI-C1		
IVSI-C2		
IVSI-C4		
IVSI-Z3		
IVSI-Z4		
5	2-1/2	10-1/4
6	3	10-1/4
8	4	13-5/8
10	5	17
12	6	20-1/2
14	7	24
16	8	27-3/8
18	9	30-3/4
20	10	34-1/8
22	11	37-5/8
24	12	41
26	13	44-3/8
28	14	47-7/8
30	15	51-1/4
32	16	54-5/8
36	18	61-1/2
42	21	71-3/4
48	24	82

Insulated Exit Cone

Code:
EC

Will increase stack exit velocity 1 1/2 times. Requires
a drain at bottom of stack.

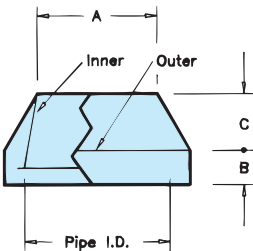

Materials Available:

316

Ordered Part Includes:
One inner cone, one outer finish collar, and one VB.

- Notes:
- 1. $K = 1.25$ Flow Resistance

Product (Pipe I.D.)	Dimensions (Inches)		
All Models	A	B	C
5	4-7/8	4	1-3/8
6	4-7/8	4	1-1/2
8	6-9/16	4	1-3/4
10	8-3/16	4	3-3/8
12	9-7/8	4	3-3/4
14	11-1/2	4	4
16	13-1/16	6	4-3/8
18	14-3/4	6	4-5/8
20	16-5/16	6	5
22	18	6	5-1/4
24	19-5/8	6	5-5/8
26	21-1/4	6	6
28	22-7/8	8	6-1/4
30	24-1/2	8	6-5/8
32	26-1/8	8	6-7/8
36	29-3/8	10	7-1/2
42	34-5/16	12	8-1/2
48	39-3/16	12	9-1/2

Flip Top

Code:
FL

Termination that prevents moisture and debris from entering system. Flip top opens with internal pressure and closes when pressure is absent.

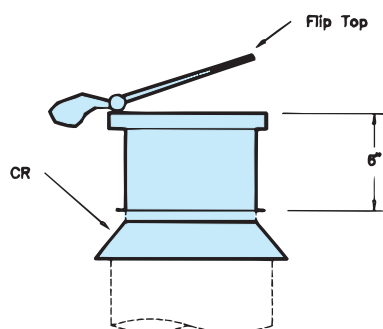
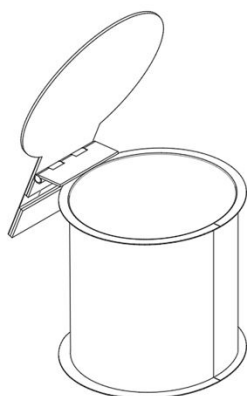

Materials Available:

Stainless Steel

Ordered Part Includes:

FL, one VB, one CR and one HCB..

Notes:

1. Available in sizes 5" through 24" only.
2. Model VSI part used for IVSIC1 applications.

Miter Cut

Code:
MC

Used for horizontal engine exhaust termination.

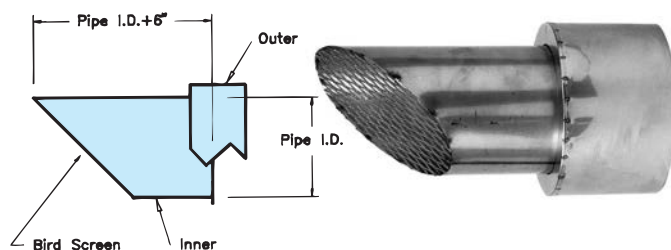

Materials Available:

316

Ordered Part Includes:

One inner with bird screen, one outer finish collar, and one VB.

Notes:

1. The 1/2" mesh-pattern bird screen has a 60 percent open area.
2. $K = 1.25$ Flow Resistance Factor

Excessive Pressure Relief Valve

Code:
ER

For use on all engine exhaust Helps control the venting pressure should a backfire occur.



Recommended orientation as shown.

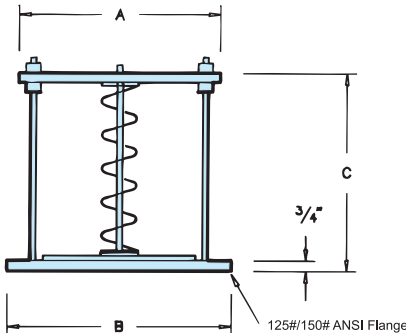

Ordered Part Includes:
Painted steel ER valve, plus bolt flange gasket, bolts, washers and nuts for attachment to FD. Painted steel construction.

- Notes:
- 1. Excessive Pressure Relief Valves are recommended in accordance with NFPA 37.
 - 2. Caution must be used in locating valve in an exhaust system. Hot gases and high velocity could cause injury.
 - 3. Number of Snubber Springs, Tension Springs, Support Rods, and Guide Rods vary with valve size.
 - 4. Model VSI part used for all IVSI applications.

VSI IVSI (Pipe I.D.)	Dimensions (Inches)			No. of Springs
	A	B	C	
5	8-5/8	10	10-3/4	1
6	9-5/8	11	10-3/4	1
8	12-5/8	13-1/2	10-3/4	1
10	14	16	10-3/4	1
12	16-3/4	19	10-3/4	2
14	18-1/4	21	10-3/4	2
16	20-1/4	23-1/2	10-3/4	3
18	22-1/4	25	10-3/4	3
20	24-1/4	27-1/2	10-3/4	4
22	26-1/4	29-1/2	10-3/4	4
24	28-1/2	32	10-3/4	4

Guy Section

Code:
GS

A rigid, factory-welded section for attaching guys to chimney stack.

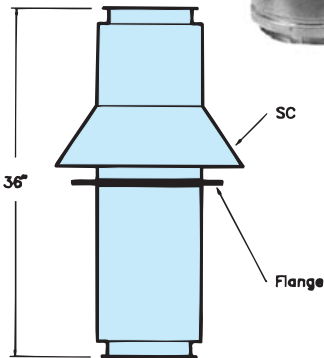

Materials Available:

304/Alum	316/Alum	304/304	316/316
----------	----------	---------	---------

Note: Alum is aluminized steel

Ordered Part Includes:
Welded pipe section, with painted carbon steel flange, storm collar SC, one AS, one VB and one CB.

- Notes:
- 1. Flange has 13/16" diameter holes, 30° apart.
 - 2. Flow Resistance Factor (K) is the same as insulated pipe.

No Tool Access Cap

Code:
NTAC

Provides for toolless cleanout at
end of manifold when connected
to MT or JL.

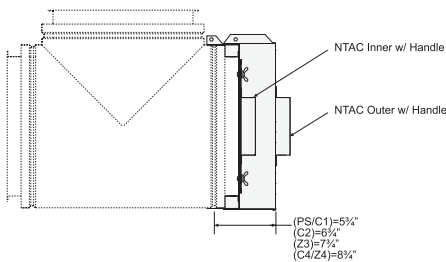

Materials Available:

304/Alum	316/Alum	304/304	316/316
----------	----------	---------	---------

Note: Alum is aluminized steel

Ordered Part Includes:
NATC, plus one dam, insulation shield,
outer cover, and one VB. Ceramic fiber Insulation provided
for IVSI models.

Special Manifold Tee (Sprinkler)

Provides access for installation/
inspection of sprinkler head.

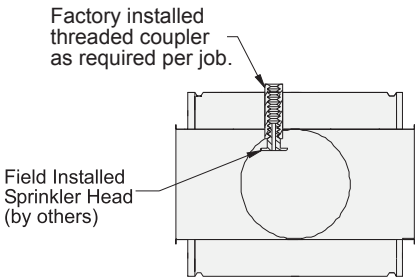

Materials Available:

304/Alum	316/Alum	304/304	316/316
----------	----------	---------	---------

Note: Alum is aluminized steel

Ordered Part Includes:
NTS, plus one VB for the body diameter, one VB for the snout
diameter, one AS for the body diameter, and one CB for the
body diameter.

- Notes:
1. Use NTAC for access cover.
 2. Snout available in any standard diameter equal to or smaller
then the body diameter.
 3. For dimension see 90° Manifold Tee in this booklet.
 4. K= straight pipe plus an unknown for the sprinkler head.
Contact sprinkler head manufacturer.

Through-Penetration Firestop

Code:
TPF

Use when penetrating a 2 hour fire-rated floor or wall with IVSI-Z3 or IVSI-Z4 grease duct.



Materials Available:

Aluminized Steel	304 or 316 Stainless Steel
------------------	----------------------------

Ordered Part Includes:

One closure band, two cover plate halves, 12-inch wide insulation strip and one 4-inch insulation strip.

Notes:

- 1. For use with IVSI-Z3 and IVSI-Z4 grease duct only
- 2. One kit required for a floor penetration and two kits requires for wall penetrations.

Inline Access Door

Code:
IAD

Provides access for inspection and cleaning; incorporates a flush mount door on a 30" duct section.

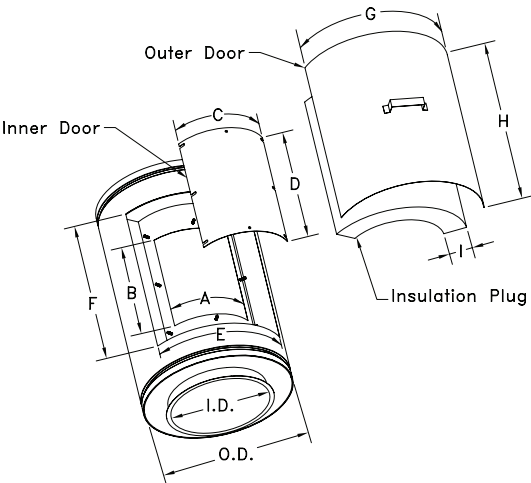

Materials Available:

304/Alum	316/Alum	304/304	316/316
----------	----------	---------	---------

Note: Alum is aluminized steel

Ordered Part Includes:

IAD component, plus one VB, one AS, and one CB.

Product	Inner Hole Size (inches)		Inner Door Size (inches)		Outer Hole Size (inches)		Outer Door Size (inches)	
Pipe I.D.	A	B	C	D	E	F	G	H
5 & 6	3½	12	6	14½	9½	18½	12	21
8 & 10	6	12	8½	14½	12	18½	14½	21
12 - 16	9	12	11½	14½	15	18½	17½	21
18 - 22	13	12	15½	14½	19	18½	21½	21
24 - 30	18	12	20½	14½	24	18½	26½	21
32 & 36	24	12	26½	14½	30	18½	32½	21

Notes:

- 1. IAD available on 30" Pipe Lengths only.
- 2. Inner door is secured in place with wing nuts.
- 3. Outer door is secured in place with snap-down latches.
- 4. Outer door for double wall models only (VSI, IVSI & ZC).

Several special parts, such as those shown here, are available upon request.

Please provide detail of the required part if not already designed by AMPCO, and allow extra manufacturing time. Special parts are nonreturnable.

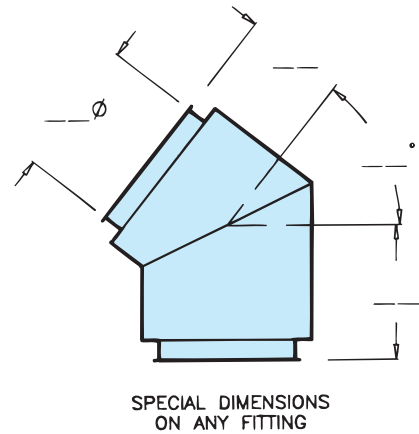
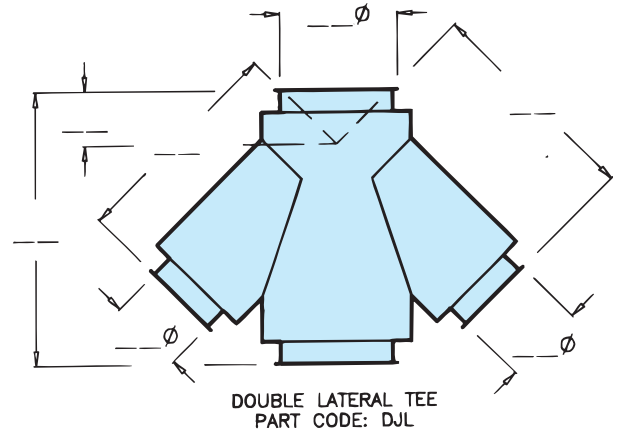
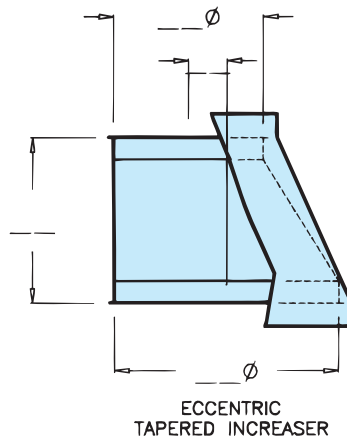
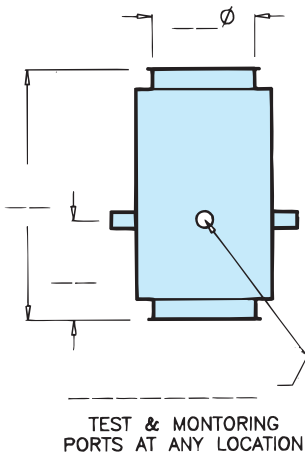

SPECIAL DIMENSIONS
ON ANY FITTING

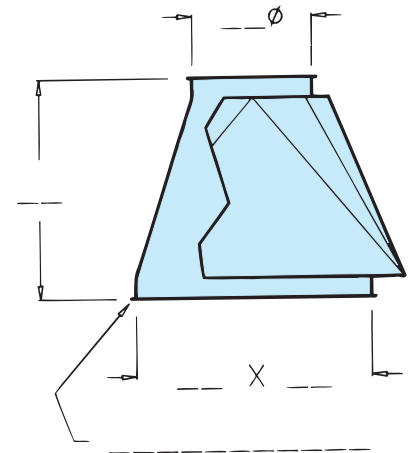
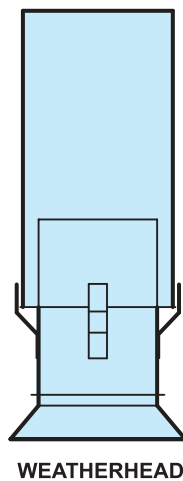

SINGLE WALL PART CODE: ___x___SWA

DOUBLE WALL PART CODE: ___x___DWA

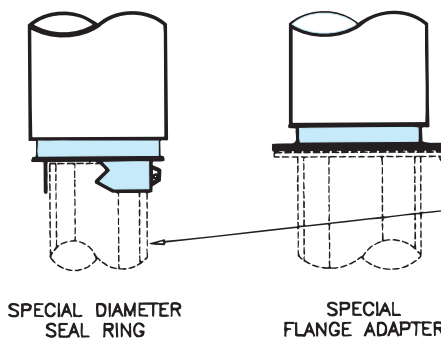

PROVIDE PRECISE DETAIL
OF EXISTING PIPE OR
FLANGE FOR ATTACHMENT

Material Thickness - Model VSI/IVSI

Diameter	Inner		Outer	
	Gauge *	Material	Gauge*	Material
5"-32"	20	.035" - 304 SS or	24	.025" Alum Steel or
	20	.035" - 316 SS	24	304 & 316 SS
36"	20	.035" - 304 SS or	21	.034" Alum Steel or
	20	.035" - 316 SS	20	.034" 304 & 316 SS
38"-48"	18	.048" - 304 SS or	21	.034" Alum Steel or
	18	.048" - 304 & 316 SS	20	.035" 304 & 316 SS

* Gauge is approximate.

Approximate Outer Pipe Surface Temperatures

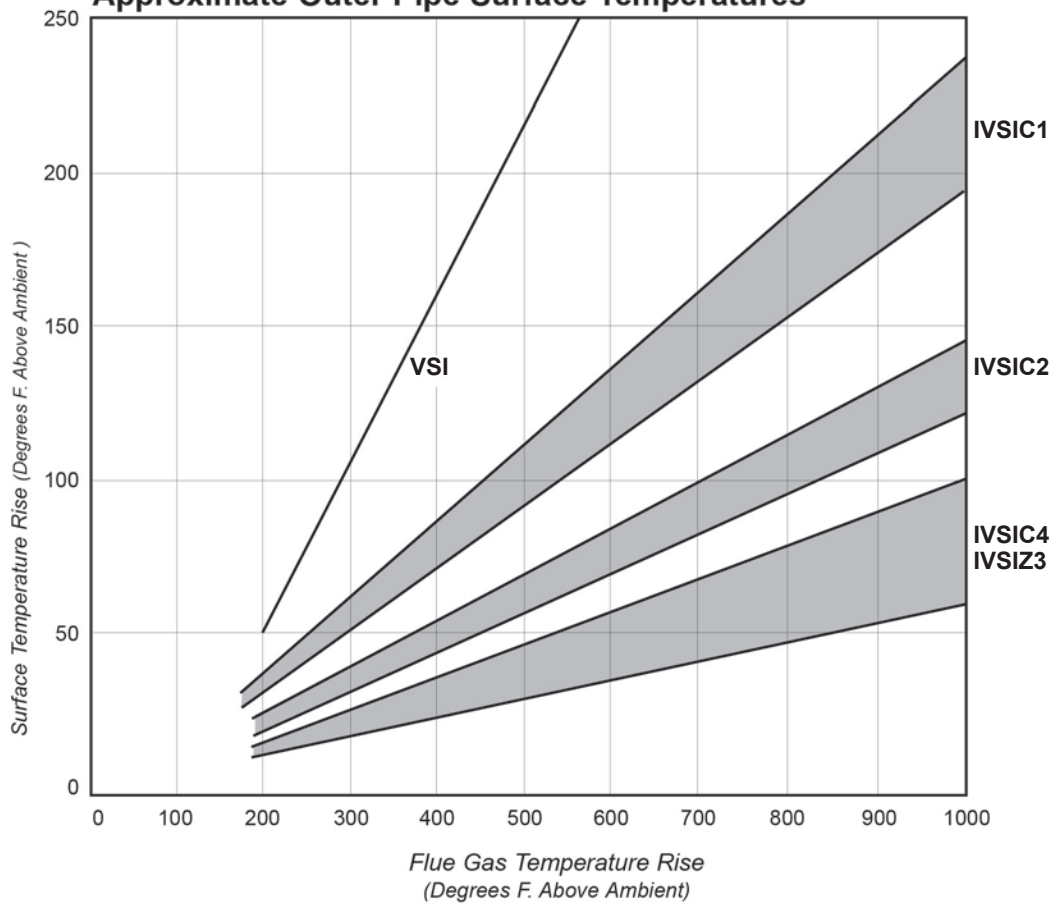

Operating Temperatures and Clearances to Combustibles

Criteria	Restaurant Grease Duct	Type L Vent	1400° F. Factory-Built Chimney	Building Heating Appliance Chimney*
Application	Cooking Appliances Ventilation Hoods Restaurant Grease Ducts Pizza Oven Exhausts	Chimneys and stacks for appliances listed suitable for venting with Type L or Type B venting systems.	Industrial Furnaces Processing Equipment Kilns and Ovens Diesel and Turbine Exhausts Coffee Roasters	Low and High Pressure Steam Boilers Diesel and Turbine Exhausts Building Heating Equipment Coffee Roasters
Maximum Operating Temperatures	500° F. Continuous 2000° F. Intermittent	550° F Continuous 1700° F. Intermittent	1400° F. Continuous 1800° F. Intermittent	1000° F. Continuous 1400° F. Intermittent
Clearances To Combustibles: Model VSI	5", 6", 8", 10" I.D. = 5" 12" I.D. = 6" 14" I.D. = 7" 16" I.D. = 8" 18" I.D. = 9" 20" I.D. = 10" 22"-24" I.D. = 11" 26"-28" I.D. = 12" 30"-32" I.D. = 13" 36" I.D. = 14" 42" I.D. = 16" 48" I.D. = 17"	VSI not listed as L-Vent	5"-16" I.D.=6" 18" I.D.=8" 20" I.D.=9" 22" I.D.= 10" 24" I.D.=12" 26" I.D.=13" 28" I.D.=14" 30" I.D.=16" 32" I.D.=17" 34" I.D.=19" 36"-48" I.D. = 20	5"-16" I.D.= 6" 18"-20" I.D.= 7" 22"-26" I.D.= 8" 28"-30" I.D.= 9" 32"-36" I.D.= 10" 42" I.D.=11" 48" I.D.=12"
Model IVSIC1	5"-6" I.D. = 2" 8"-16" I.D. = 3" 18"-24" I.D. = 4" 26"-32" I.D. = 5" 36" I.D. = 6" 42"-48" I.D. = 7"	5"-24" I.D. = 3"	5"-6" I.D. = 1" 8"-16" I.D. = 2" 18"-24" I.D. = 3" 26"-32" I.D.= 4" 36" I.D. = 5" 42"-48" I.D. = 6"	5"-8" I.D. = 1" 10"-16" I.D. = 2" 18"-24" I.D. = 3" 26"-32" I.D. = 4" 36" I.D. = 5" 42"-48" I.D. = 6"
Models IVSI C2 & C4	5"-16" I.D. = 1" 18"-20" I.D. = 2" 22"-24" I.D.= 3" 26"-32" I.D.= 4" 36" I.D. = 5" 42"-48" I.D.= 6"	5"-24" I.D. = 2"	5"-16" I.D. = .5" 18"-24" I.D. = 2" 26"-32" I.D. = 3" 36" I.D. = 4" 42"-48" I.D. = 5"	5"-16" I.D. = .5" 18" I.D. = 1" 20" I.D. = 1.5" 22"-24" I.D.= 2" 26"-32" I.D.= 3" 36" I.D.= 4" 42"-48" I.D.=5"
Model IVSI Z3 & Z4	5"-36" I.D. = 0"			
Clearance to non-combustibles - as required for installation, access for inspection or per local code.				

1. Enclosure - Grease Ducts, Building Heating appliance Chimneys and 1400 F chimneys are intended for use unenclosed or enclosed in an appropriate non-combustible chase.
2. Under the "Building Heating Appliance Chimney" Listing, 5" through 24" Model IVSI has qualified for UL's additional, optional "Type HT" rating for chimneys for certain appliance venting applications; especially solid fuel.



BUILD FOR THE FUTURE

Customer Service and Support:

Airmate (USA).....	800.992.8368
Airmate (CAN)	888.735.5475
Ameriflow	800.252.8467
Amerivent (Retail)	800.252.8467
Amerivent (Hearth & Wholesale)	800.423.4270
Amerivent (Support).....	800.748.0392
AMPCO (USA)	800.669.3269
AMPCO (CAN).....	888.735.5475
Duravent	800.835.4429
Hart & Cooley	800.433.6341
Hart & Cooley (Support)	800.748.0392
Heatfab (USA)	800.772.0739
Heatfab (CAN)	800.848.2149
Lima.....	800.423.4270
Milcor	800.774.5240
Portals Plus.....	800.774.5240
RPS.....	800.624.8642
Security Chimney (USA).....	800.361.4909
Security Chimney (CAN)	800.667.3387
Selkirk (USA) Residential	800.992.8368
Selkirk (USA) Commercial.....	800.848.2149
Selkirk (USA) Support.....	800.748.0392
Selkirk (CAN)	888.735.5475

Manufacturing & Distribution Centers:

CANADA	
Nobel, ON	Manufacturing
Laval, QC	Manufacturing
Prescott, ON	Distribution
USA	
Grand Rapids, MI	Center of Excellence
Dallas, TX	Distribution
Englewood, OH	Distribution
Huntsville, AL	Manufacturing & Distribution
Mira Loma, CA	Distribution
Nampa, ID	Manufacturing & Distribution
Turner Falls, MA	Manufacturing & Distribution
Vacaville, CA	Manufacturing
MEXICO	
Ojinaga, MX	Manufacturing
Mexicali, MX	Manufacturing

Corporate Headquarters:

Duravent Group
28 W. Adams, Suite 1810
Detroit, MI 48226
Tel: 800.835.4429
Email: info@duraventgroup.com
www.duraventgroup.com



BUILD FOR THE FUTURE

www.duraventgroup.com

